

SC 3-JAW SCROLL CHUCKS

普通型三爪夾頭

尺寸圖 » Dimensions

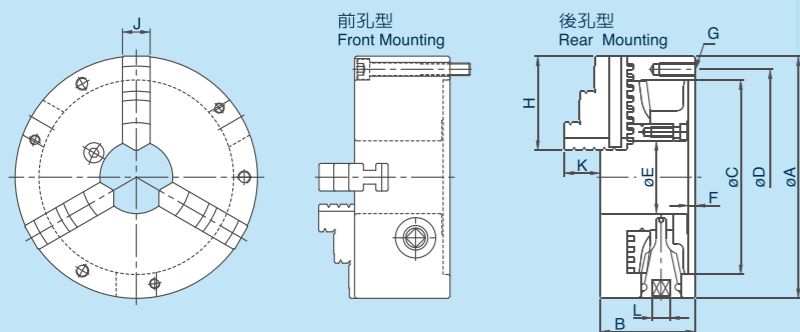

規格表 » Specifications

單位/UNIT:mm

型式/規格 MODEL /SPEC.	A	B	C	D	E	F	G	H	J	K	L	最高迴轉速 Max.Speed r.p.m.(min ⁻¹)	把握範圍 外徑把握 O.D.Clamping	Max. Gripping Diameter 內徑把握 I.D.Clamping	淨重 Weight (kg)
SC-03	85	45	60	73	16	3.5	3-M6x1P	35	11	15	7	2500	ø2-ø70	ø24-ø64	1.5
SC-04	112	58	80	95	24	4.5	3-M8x1.25P	42	14	17	8	2500	ø3-ø90	ø32-ø84	3.3
SC-05	132	60	100	115	32	4.5	3-M8x1.25P	50	16	20	8	2500	ø3-ø110	ø35-ø100	4.6
SC-06	167	66	130	147	45	5	3-M10x1.5P	65	19	23	10	2000	ø4-ø160	ø48-ø150	7.9
SC-07	193	76	155	172	58	5	3-M10x1.5P	75	22	28	11	2000	ø4-ø180	ø56-ø170	12.0
SC-08	203	76	160	176	58	5	3-M10x1.5P	75	22	28	11	2000	ø4-ø180	ø56-ø170	13.3
SC-09	233	84	190	210	70	5.5	3-M12x1.75P	85	24	34.5	12	2000	ø5-ø220	ø62-ø210	19.3
SC-10	273	86	230	250	89	5.5	3-M12x1.75P	98	28	39	12	1800	ø6-ø260	ø70-ø250	26.2
SC-12	310	96	260	285	105	7	3-M12x1.75P	110	30	45	14	1800	ø10-ø300	ø86-ø290	37.6
SC-14	355	112	300	328	127	7	6-M12x1.75P	132	35	50	15	1500	ø12-ø350	ø96-ø320	57.2
SC-16	405	122	345	375	160	8	6-M14x2P	146	40	56	15	1500	ø14-ø400	ø100-ø380	80.7

PS 4-JAW SCROLL CHUCKS

連動型四爪夾頭

尺寸圖 » Dimensions

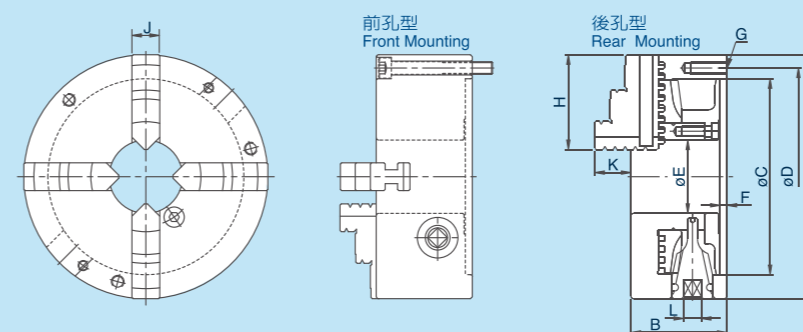

規格表 » Specifications

單位/UNIT:mm

型式/規格 MODEL /SPEC.	A	B	C	D	E	F	G	H	J	K	L	最高迴轉速 Max.Speed r.p.m.(min ⁻¹)	把握範圍 外徑把握 O.D.Clamping	Max. Gripping Diameter 內徑把握 I.D.Clamping	淨重 Weight (kg)
PS-07	193	76	155	172	58	5	3-M10x1.5P	75	22	28	11	2000	ø4-ø180	ø56-ø170	12.1
PS-09	233	84	190	210	70	5.5	3-M12x1.75P	85	24	34.5	12	2000	ø5-ø220	ø62-ø210	19.4
PS-12	310	96	260	285	105	7	3-M12x1.75P	110	30	45	14	1800	ø10-ø300	ø86-ø290	38.1
PS-16	405	122	345	375	160	8	6-M14x2P	146	40	56	15	1500	ø14-ø400	ø100-ø380	82.4

AS 6-JAW AWL TYPE CHUCKS

錐型六爪夾頭

尺寸圖 » Dimensions

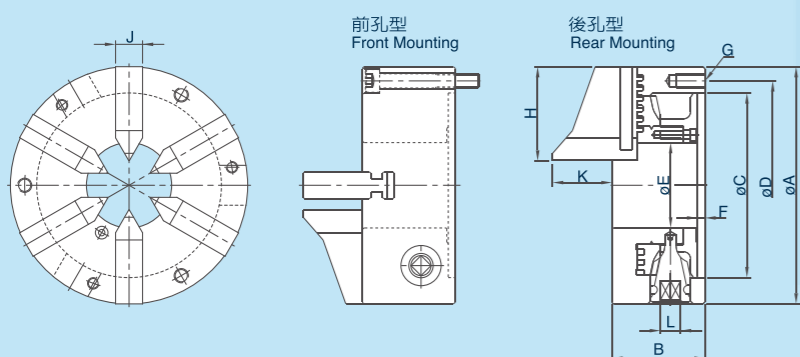

規格表 » Specifications

單位/UNIT:mm

型式/規格 MODEL /SPEC.	A	B	C	D	E	F	G	H	J	K	L	最高迴轉速 Max.Speed r.p.m.(min ⁻¹)	把握範圍 外徑把握 O.D.Clamping	Max. Gripping Diameter 內徑把握 I.D.Clamping	淨重 Weight (kg)
AS-04	112	58	80	95	32	4.5	3-M8x1.25P	45	14	46	8	1200	ø2-ø32		3.8
AS-06	167	65	130	147	60	5.0	3-M10x1.5P	66	19	43	10	1200	ø3-ø60		8.2

AE 8-JAW AWL TYPE CHUCKS

錐型八爪夾頭

尺寸圖 » Dimensions

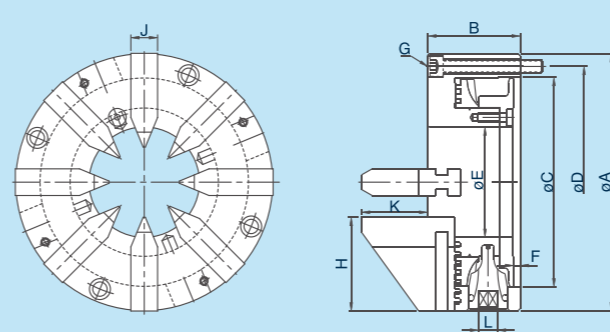

規格表 » Specifications

單位/UNIT:mm

型式/規格 MODEL /SPEC.	A	B	C	D	E	F	G	H	J	K	L	最高迴轉速 Max.Speed r.p.m.(min ⁻¹)	把握範圍 外徑把握 O.D.Clamping	Max. Gripping Diameter 內徑把握 I.D.Clamping	淨重 Weight (kg)
AE-09	233	84	190	210	100	5.5	4-M12x1.75P	85	24	60	12	1000	ø7-ø100		21

SK 3-JAW POWEREULY.P-E SCROLL CHUCKS

強力型三爪夾頭

R -11m» Dimensions

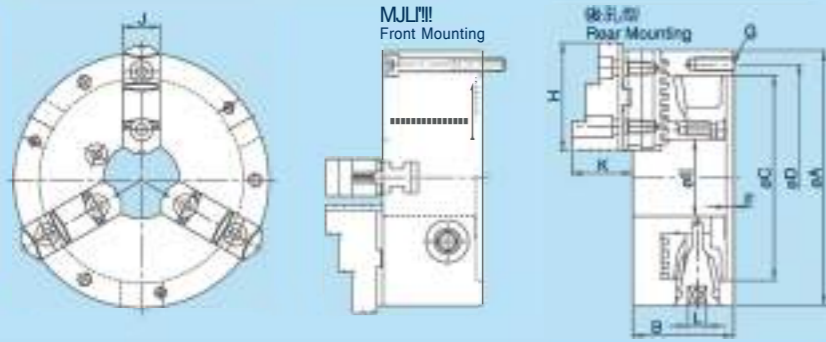

m, ffl» Specifications

φfil:/UNIT:mm

MODEL /SPEC.	A	B	C	D	E	F	G	H	J	K	L	Max.Speed r.p.m.(min ⁻¹)	9-10teJW O.D.Clamping	Max. Gripping Diameter φφ:teJW LO.Clamping	Weight (kg)
SK-04	112	58	80	95	24	4.5	3-M8x1.25P	47	19	31.5	8	2500	03-0100	035-093	3.45
SK-05	132	60	100	115	32	4.5	3-M8x1.25P	57	24	36	8	2500	03-0123	043-0122	5.0
SK-06	167	66	130	147	45	5	3-M10x1.5P	68	26	39	10	2000	08-0160	055-0150	8.6
SK-07	193	76	155	172	58	5	3-M10x1.5P	82	28	43	11	2000	08-0180	062-0170	12.8
SK-08	203	76	160	176	58	5	3-M10x1.5P	82	28	43	11	2000	08-0180	062-0170	14.1
SK-09	233	84	190	210	70	5.5	3-M12x1.75P	93	32	50	12	2000	011-0220	070-0210	20.4
SK-10	273	86	230	250	89	5.5	3-M12x1.75P	102	32	54.5	12	1800	012-0260	080-0250	26.7
SK-12	310	96	260	285	105	7	3-M12x1.75P	118	40	56	14	1800	015-0300	090-0290	39.3
SK-14	355	122	300	328	127	7	6-M12x1.75P	139	45	70.5	15	1500	025-0350	0110-0320	60.7
SK-16	405	122	345	375	160	8	6-M14x2P	150	50	75	15	1500	030-0400	0110-0380	82.3
SK-20	500	140	420	458	205	5.5	6-M16x2P	140	55	84	19	1000	025-0480	0125-0460	145.5

PSK 4-JAW POWEREULY.P-E SCROLL CHUCKS

強力連動型四爪夾頭

R -11Pi» Dimensions

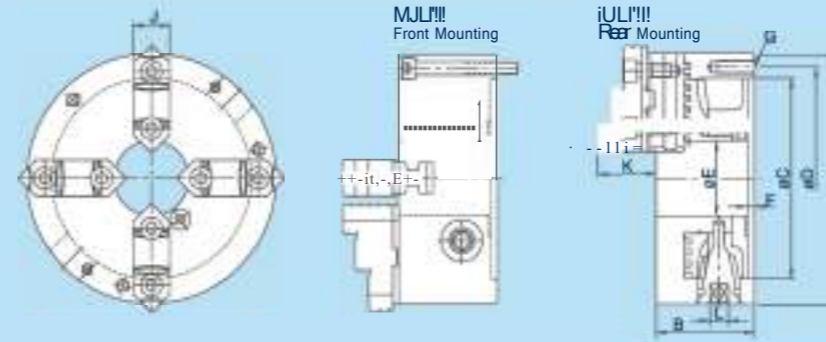

m, ffl» Specifications

φfil:/UNIT:mm

MODEL /SPEC.	A	B	C	D	E	F	G	H	J	K	L	Max.Speed r.p.m.(min ⁻¹)	9-10teJW O.D.Clamping	Max. Gripping Diameter φφ:teJW LO.Clamping	Weight (kg)
PSK-07	193	76	155	172	58	5	3-M10x1.5P	82	28	43	11	2000	08-0180	062-0170	12.7
PSK-09	233	84	190	210	70	5.5	3-M12x1.75P	93	32	50	12	2000	011-0220	070-0210	20.8
PSK-12	310	96	260	285	105	7	3-M12x1.75P	118	40	56	14	1800	015-0300	090-0290	43
PSK-16	405	122	345	375	160	8	6-M14x2P	150	50	75	15	1500	030-0400	0110-0380	86.7
PSK-20	500	140	420	458	205	5.5	6-M16x2P	140	55	84	19	1000	025-0480	0125-0460	149

A1(A2) 3-JAW A1 (A2) TYPE CHUCKS

直裝型三爪夾頭

R -1111» Dimensions

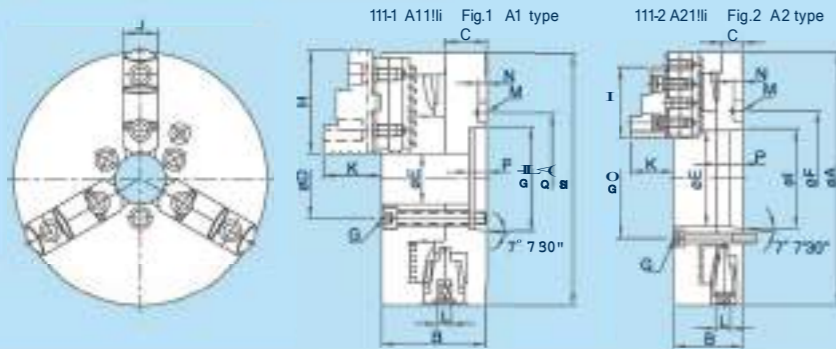

m, ffl» Specifications

φfil:/UNIT:mm

MODEL /SPEC.	A	B	C	D	E	F	G	H	I	J	K	L	p	M	N	Reference Drawing	Max.Speed r.p.m.(min ⁻¹)	Max. Gripping Diameter φφ:teJW LO.Clamping	Weight (kg)	
A,5-08"	200	83	33.5	61.9	40	0104.8	3-M10x1.5P	82	82.563	28	43	11	14.29	016.3	6.8	111-1 fig.1	2000	08-0180	062-0170	17.4
A,6-08"	200	83	33.5	82.6	56	0133.4	3-M12x1.75P	82	106.375	28	43	11	15.88	019.3	6.8	111-1 fig.1	2000	08-0180	062-0170	18
A16-10"	255	91.5	36.5	82.6	56	0133.4	3-M12x1.75P	93	106.375	32	50	12	15.88	019.3	6.8	111-1 fig.1	1800	011-0240	070-0230	30.6
A211-20"	500	135	40	235	190.5	0235	6-M20x2.5P	140	196.869	55	84	19	-	029.4	10.7	111-2 fig.2	1000	025-0480	0125-0460	161.5

D1 3-JAW TYPE CHUCKS

直裝型三爪夾頭

R -11111» Dimensions

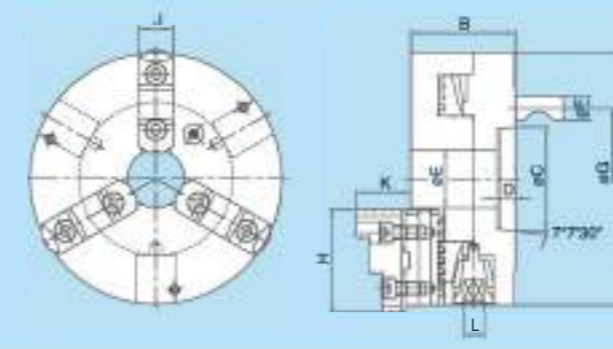

m, ffl» Specifications

φfil:/UNIT:mm

MODEL /SPEC.	A	B	C	D	E	F	G	H	J	K	L	Max.Speed r.p.m.(min ⁻¹)	9-10teJW O.D.Clamping	Max. Gripping Diameter φφ:teJW LO.Clamping	Weight (kg)
D,5-08"	200	83	82.563	15	46	19	104.8	82	28	43	11	2000	08-0180	062-0170	17.8
D,6-08"	200	83	106.375	16	58	22.2	133.4	82	28	43	11	2000	08-0180	062-0170	17.3
D,6-10"	255	94	106.375	16	76	22.2	133.4	93	32	50	12	1800	011-0240	070-0230	31.3
D,8-10"	255	94	139.719	18	76	25.4	171.4	93	32	50	12	1800	011-0240	070-0230	30.9
D,8-12"	310	105	139.719	18	103	25.4	171.4	118	40	56	14	1800	015-0300	090-0290	51.1
D,11-20"	500	135	196.869	-	190.5	30.2	235	140	55	84	19	1000	025-0480	0125-0460	165.5

強力超薄型夾盤

- 1.把手和盤面成30°角，旋轉操作更便利。
- 2.薄型設計，可增加機械加工之容許長度。
- 3.外徑成凸緣設計，裝卸容易。
- 4.強力型設計可共用生爪。

尺寸圖 » Dimensions

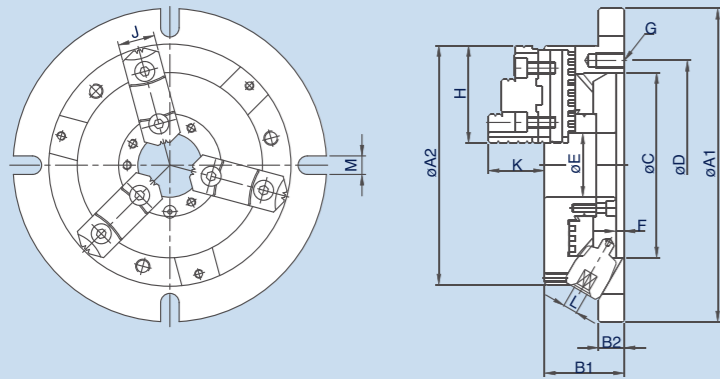

- 1.The handle with an angle of 30 degrees is much convenient for operations.
- 2.The "super thin thickness" design of chucks increase the "allowable distance" of machining operations.
- 3.Chuck flange makes loading and unloading operations simpler and more convenient.
- 4.Hard jaws and Soft jaws can be used alternatively.

方型超薄夾盤

- 1.MC 均為定寸研磨方式；任何相同規格之方型夾盤 W,X,Y,Z 各點之高度公差為0.05mm以內。
- 2.MC規格均可替換生爪，作不規則形狀之加工，以替代中心機大量治具，更經濟、方便。
- 3.硬爪重複夾持之精度公差為0.02mm 以內。
- 4.側邊平行校正後，硬爪夾持之平行公差為0.05mm以內。

尺寸圖 » Dimensions

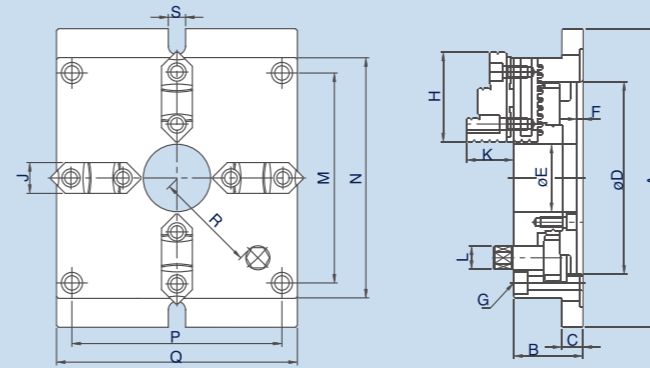

- 1.MC chucks are precisely ground, the tolerances of W,X,Y,Z among chucks are within 0.05mm.
- 2.Soft jaws can be used alternatively for machining special shaped work pieces, to substitute for designing and making a lot of jigs for this purpose.
- 3.The repetitive gripping accuracy with the hard jaws are within 0.02mm.
- 4.Parallel gripping accuracy with hard jaws can be controlled within 0.05mm after aligning sides of chucks.

規格表 » Specifications

單位/UNIT:mm

型式/規格 MODEL / SPEC.	A1	A2	B1	B2	C	D
NBK-06	220	170	58	18	130	147
NBK-08	270	210	65	20	155	172
NBK-10	315	255	73	20	190	210
NBK-12	370	305	80	22	250	285

型式/規格 MODEL / SPEC.	E	F	G	H	J	K
NBK-06	45	6	3-M10x1.5P	68	26	40
NBK-08	60	6	3-M10x1.5P	82	28	43
NBK-10	80	6	3-M12x1.75P	93	32	52
NBK-12	105	5	3-M12x1.75P	118	40	59

型式/規格 MODEL / SPEC.	L	M	把握範圍 Max.Gripping Diameter		淨重 Weight (kg)
			外徑把握 O.D.Clamping (mm)	內徑把握 I.D.Clamping (mm)	
NBK-06	10	13	ø8~ø160	ø48~ø150	10.6
NBK-08	11	13	ø11~ø200	ø62~ø190	18.1
NBK-10	12	16	ø12~ø250	ø72~ø240	27.9
NBK-12	14	18	ø15~ø300	ø86~ø290	42.9

使用範例 » Operation Example

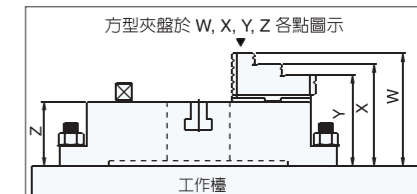

單位/UNIT:mm

規格表 » Specifications

型式/規格 MODEL / SPEC.	A	B	C	D	E	F	G	H	J	K	L	M
MC-06	215	57	18	130	40	5.5	4-M10x1.5P	68	26	39	14	144
MC-08	250	65	20	160	55	6	4-M12x1.75P	82	28	43	17	174
MC-10	310	72	22	200	70	6	4-M14x2P	93	32	50	21	218
MC-12	380	85	25	260	100	7	4-M16x2P	118	40	56	23	274

型式/規格 MODEL / SPEC.	N	P	Q	R	S	把握範圍 Max.Gripping Diameter		淨重 Weight (kg)
						外徑把握 O.D.Clamping (mm)	內徑把握 I.D.Clamping (mm)	
MC-06	165	144	165	66	18	ø4-ø128	ø55-ø128	11.4
MC-08	200	174	200	83	18	ø5-ø162	ø62-ø162	18.6
MC-10	250	218	250	104	18	ø6-ø200	ø72-ø200	31.6
MC-12	310	274	310	135	22	ø10-ø265	ø90-ø265	56.6

超薄型夾盤



1. Light, Thin, Short, Small "designing concept; the chucks are most fitting to hold work pieces for measuring.
2. Just rotate the chuck knob directly for gripping and loosening, A handle is not necessary to be used.
3. Chuck body is made of very durable steel.
4. Jaws can be reversibly used; gripping of various sizes becomes much convenient.
5. 2" chucks can even grip up to the smallest size of 0.8mm.

Dimensions

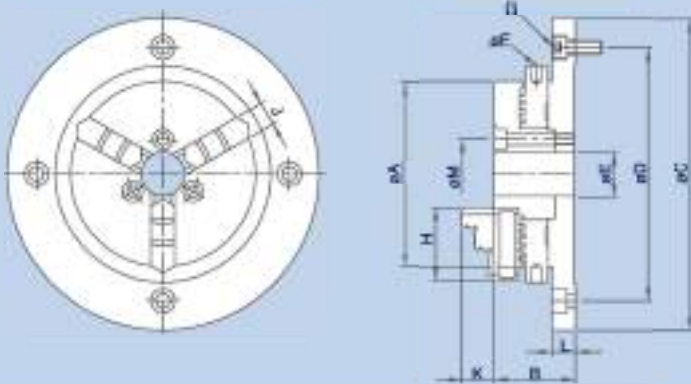

1. By the compactness comes from " Light, Thin, Short, Small " designing concept; the chucks are most fitting to hold work pieces for measuring.
2. Just rotate the chuck knob directly for gripping and loosening, A handle is not necessary to be used.
3. Chuck body is made of very durable steel.
4. Jaws can be reversibly used; gripping of various sizes becomes much convenient.
5. 2" chucks can even grip up to the smallest size of 0.8mm.

Specifications

UNIT:mm

MODEL /SPEC.	A	B	C	D	E	F
SE-02	63	28	118	100	16	4
SE-03	85	37	143	116	20	4
SE-04	110	39	168	140	26	5
SE-05	130	45	202	168	32	6
SE-06	160	52	248	208	50	8

MODEL /SPEC.	G	H	J	K	L
SE-02	4-M5x0.8P	27	8	13	8
SE-03	4-M6x1P	35	11	15	10.5
SE-04	4-M6x1P	42	14	19	10
SE-05	4-M8x1.25P	50	16	21	11.5
SE-06	4-M10x1.5P	65	19	26	15

MODEL /SPEC.	M	O.D.Clamping (mm)	Max.Gripping Diameter	I.D.Clamping (mm)	Weight (kg)
SE-02	26	00.8~063		023~058	1.2
SE-03	32	01~081		031~070	2.9
SE-04	40	01~0100		036~090	4.3
SE-05	49	01.5~0116		043~0106	6.2
SE-06	70	01.5~0160		052~0148	11.1