

HYDRAULIC CHUCKS



FEATURES

- Vibration damping effect
- High radial stiffness
- Flexible clamping range using reducing sleeves or possible to directly clamp the tool in the chuck
- 5 different geometries

BENEFITS

- Quick setup times
- High run-out accuracy
- Increased tool life
- No reduction in clamping force at high spindle speeds
- Exceptional performance in drilling, reaming and high speed machining

High Performance Hydraulic Chucks from WTE & YG-1

WTE hydraulic chucks are 100% made in Germany and are used by the world's leading Automotive, Aerospace and Mould & Die manufacturers.

They offer market leading performance and the very best machining results.

The YG-1 hydraulic chucks offer exceptional value on the most popular tapers of BT, DIN69871 and HSK-A whilst maintaining exceptional quality and performance.



CONTENTS

BT MAS BT30, BT40, BT50..... P1034	HSK-F HSK63-F P1040
DIN 69871 SK40, SK50..... P1036	DOUBLE CONTACT DBT40..... P1040
HSK-A HSK50-A, HSK63-A, HSK100-A..... P1038	EXTENSIONS Hydraulic Chuck Extensions..... P1040
HSK-E HSK40-E, HSK50-E..... P1040	HYDRAULIC CHUCK SLEEVES Open Type, Closed Type & Coolant Jets P1041

GEOMETRIES

SHORT & RIGID



Rigid, heavy duty model. Ideal for use with sleeves.

SLIM



Slimmer nose profile, ideal for nominal diameter clamping.

ULTRA SHORT



For extra long length drills.

LONG, SLIM & TAPERED



Ideal for 5 axis machining or mould and die.

LONG & NARROW



Slim nose profile with long reach.

LENGTHS

Lengths	BT			SK		HSK-A			HSK-E		HSK-F	DBT
	30	40	50	40	50	50	63	100	40	50	63	
Short (20-59mm)	✓	✓	-	✓	✓	-	-	-	-	-	-	-
Standard (60-100mm)	✓	✓	✓	✓	✓	✓	✓	✓	✓	✓	✓	✓
Long (105-125mm)	-	✓	✓	✓	✓	-	✓	✓	-	-	✓	✓
Extended (140-160mm)	-	✓	✓	✓	-	-	✓	-	-	-	-	-
Extra Long (200mm)	-	-	-	-	-	-	✓	-	-	-	-	-

MAXIMUM TRANSFERABLE TORQUE WITH DIRECT CLAMPING WTE CHUCKS

Clamping Diameter	6	8	10	12	14	16	18	20	25	32
Minimum clamping depth	27	27	31	36	36	39	39	41	47	51
Torque Nm	30	45	85	140	160	230	270	400	470	730

APPLICATION GUIDE

Geometry	MILLING					HOLE MAKING		
	HPC	Rough	General	HSC	Finish	Drilling	Reaming	Tapping
SHORT & RIGID	✓ ✓	✓ ✓	✓ ✓ ✓	✓ ✓ ✓	✓ ✓ ✓	✓ ✓ ✓	✓ ✓ ✓	✓
SLIM	✓	✓	✓ ✓ ✓	✓ ✓	✓ ✓ ✓	✓ ✓ ✓	✓ ✓ ✓	✓
ULTRA SHORT	✗	✗	✓	✓	✓ ✓	✓ ✓ ✓	✓ ✓ ✓	✓
LONG, SLIM & TAPERED	✗	✗	✓ ✓	✓ ✓	✓ ✓ ✓	✓ ✓ ✓	✓ ✓ ✓	✓
LONG & NARROW	✓	✓	✓ ✓ ✓	✓ ✓	✓ ✓ ✓	✓ ✓ ✓	✓ ✓ ✓	✓

✓✓✓ = 1st Choice ✓✓ = Highly Suitable ✓ = Only suitable in some applications ✗ = Not Recommended

HYDRAULIC CHUCKS BT MAS

1st Choice for Drilling, Reaming & High Speed Machining



SHORT & RIGID

- ▶ Balanced to G2.5 25,000RPM
- ▶ <3 micron run-out
- ▶ Made in South Korea



G2.5 25000 <3µm Run-out h6 BT MAS TIG P990 P1041

BALANCED 25,000RPM • G2.5

Taper	Dia.	Nose Dia.	Gauge Length	ORDER CODE	PRICE
BT30	20	41	85	BT30AD/B-HC20S-85	▲
	12	32	58	BT40AD/B-HC12S-58	▲
BT40	20	38	72.5	BT40AD/B-HC20S-72.5	▲
	12	32	69	BT50AD/B-HC12S-69	▲
BT50	20	37	90	BT50AD/B-HC20S-90	▲
	32	55	90	BT50AD/B-HC32S-90	▲

SHORT & RIGID

- ▶ Balanced to G2.5 25,000RPM
- ▶ <3 micron run-out
- ▶ Made in Germany



G2.5 25000 <3µm Run-out h6 BT MAS WTE MAPAL GROUP P990 P1041

BALANCED 25,000RPM • G2.5

Taper	Dia.	Nose Dia.	Gauge Length	ORDER CODE	PRICE
BT40	20	40.5	72.5	22.508.40.20.Z	▲
BT50	32	72	90	22.508.50.32.Z	▲

SLIM

- ▶ Balanced to G2.5 25,000RPM
- ▶ <3 micron run-out
- ▶ Made in South Korea



G2.5 25000 <3µm Run-out h6 BT MAS TIG P990 P1041

BALANCED 25,000RPM • G2.5

Taper	Dia.	Nose Dia.	Gauge Length	ORDER CODE	PRICE	
BT30	6	26	70	BT30AD/B-HC6-70	▲	
	8	28		BT30AD/B-HC8-70	▲	
	10	30		BT30AD/B-HC10-75	▲	
	BT30	12	32	85	BT30AD/B-HC12-85	▲
		14	34		BT30AD/B-HC14-85	▲
		16	38		BT30AD/B-HC16-90	▲
		18	40		BT30AD/B-HC18-90	▲
		20	42		BT30AD/B-HC20-90	▲
BT40		6	26		90	BT40AD/B-HC6-90
	8	28	BT40AD/B-HC8-90	▲		
	10	30	BT40AD/B-HC10-90	▲		
	12	32	BT40AD/B-HC12-90	▲		
	16	38	BT40AD/B-HC16-90	▲		
	20	42	BT40AD/B-HC20-90	▲		
	25	50	100	BT40AD/B-HC25-100		▲
	32	60	105	BT40AD/B-HC32-105		▲
BT50	6	26	90	BT50AD/B-HC6-90	▲	
	8	28		BT50AD/B-HC8-90	▲	
	10	30		BT50AD/B-HC10-90	▲	
	12	32		BT50AD/B-HC12-90	▲	
	16	38		BT50AD/B-HC16-90	▲	
	20	42		BT50AD/B-HC20-90	▲	
	25	50		105	BT50AD/B-HC25-105	▲
	32	60		115	BT50AD/B-HC32-115	▲

SLIM

- ▶ Balanced to G2.5 25,000RPM
- ▶ <3 micron run-out
- ▶ Made in Germany



G2.5 25000 <3µm Run-out h6 BT MAS WTE MAPAL GROUP P990 P1041

BALANCED 25,000RPM • G2.5

Taper	Dia.	Nose Dia.	Gauge Length	ORDER CODE	PRICE		
BT30	6	26	50.8	22.507.30.06.Z	▼		
	8	28		22.507.30.08.Z	▼		
	10	30		22.507.30.10.Z	▼		
	12	32		22.507.30.12.Z	▼		
	BT30	14	34	90	22.507.30.14.Z	▼	
		16	38		22.507.30.16.Z	▼	
		18	40		22.507.30.18.Z	▼	
		20	42		22.507.30.20.Z	▼	
BT40		6	26		90	22.507.40.06.Z	▲
		8	28			22.507.40.08.Z	▲
	10	30	22.507.40.10.Z	▲			
	12	32	22.507.40.12.Z	▲			
	14	34	22.507.40.14.Z	▼			
	16	38	22.507.40.16.Z	▲			
	18	40	22.507.40.18.Z	▼			
	20	42	22.507.40.20.Z	▲			
BT50	25	55	110	22.507.40.25.Z	▼		
	32	63		22.507.40.32.Z	▼		
	6	26		22.507.50.06.Z	▼		
	8	28		22.507.50.08.Z	▼		
	10	30		22.507.50.10.Z	▼		
	12	32		22.507.50.12.Z	▼		
	14	34		22.507.50.14.Z	▼		
	16	38		22.507.50.16.Z	▼		
BT50	18	40	22.507.50.18.Z	▼			
	20	42	22.507.50.20.Z	▼			
	25	55	22.507.50.25.Z	▼			
	32	63	22.507.50.32.Z	▼			

▲ UK stock - Generally x-stock for next day delivery ▼ European stock - Generally 2-3 days delivery (please check for lead times)

Detailed dimensions available at cutwel.co.uk. Alternatively contact our sales team for a copy of the technical information.



HYDRAULIC CHUCKS BT MAS

1st Choice for Drilling, Reaming & High Speed Machining



ULTRA SHORT

- ▶ Balanced to G2.5 25,000RPM
- ▶ <3 micron run-out
- ▶ Designed for extra long drills
- ▶ Made in South Korea



ULTRA SHORT

- ▶ Balanced to G2.5 25,000RPM
- ▶ <3 micron run-out
- ▶ Designed for extra long drills
- ▶ Made in Germany

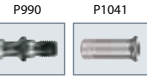

BALANCED 25,000RPM • G2.5

Taper	Dia.	Nose Dia.	Gauge Length	ORDER CODE	PRICE
BT40	20	49.5	32.5	BT40-HC20-24.6 ▲	

BALANCED 25,000RPM • G2.5

Taper	Dia.	Nose Dia.	Gauge Length	ORDER CODE	PRICE
BT40	20	48	32.5	22.501.40.20.Z ▼	£361.83

LONG, SLIM & TAPERED

- ▶ Balanced to G2.5 25,000RPM
- ▶ 3° taper (per side), ideal for moulds
- ▶ <3 micron run-out
- ▶ Made in South Korea

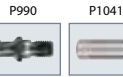

LONG & NARROW

- ▶ Balanced to G2.5 25,000RPM
- ▶ <3 micron run-out
- ▶ Made in Germany

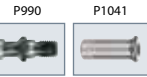

BALANCED 25,000RPM • G2.5

Taper	Dia.	Nose Dia.	Taper Length	Gauge Length	ORDER CODE	PRICE
BT40	6	20	70	120	BT40AD/B-HMC6-120 ▲	
	6	20	100	150	BT40AD/B-HMC6-150 ▲	
	8	22	70	120	BT40AD/B-HMC8-120 ▲	
	8	22	100	150	BT40AD/B-HMC8-150 ▲	
	10	24	70	120	BT40AD/B-HMC10-120 ▲	
	10	24	100	150	BT40AD/B-HMC10-150 ▲	
	12	25	70	120	BT40AD/B-HMC12-120 ▲	
	12	25	100	150	BT40AD/B-HMC12-150 ▲	
	16	32	70	120	BT40AD/B-HMC16-120 ▲	
	16	32	100	150	BT40AD/B-HMC16-150 ▲	
20	34	93	120	BT40AD/B-HMC20-120 ▲		

BALANCED 25,000RPM • G2.5

Taper	Dia.	Nose Dia.	Nose Length	Gauge Length	ORDER CODE	PRICE		
BT40	6	26	29	140	22.507.40.06.Z/140 ▼			
	8	28	30		22.507.40.08.Z/140 ▼			
	10	30	35		22.507.40.10.Z/140 ▼			
	12	32	40		22.507.40.12.Z/140 ▼			
	14	34	40		22.507.40.14.Z/140 ▼			
	16	38	45		22.507.40.16.Z/140 ▼			
	18	40	46		22.507.40.18.Z/140 ▼			
	20	42	47		22.507.40.20.Z/140 ▼			
	25	55	75		22.507.40.25.Z/140 ▼			
	32	63	61		22.507.40.32.Z/140 ▼			
	BT50	6	26		29	140	22.507.50.06.Z/140 ▼	
		8	28		30		22.507.50.08.Z/140 ▼	
10		30	35	22.507.50.10.Z/140 ▼				
12		32	40	22.507.50.12.Z/140 ▼				
14		34	40	22.507.50.14.Z/140 ▼				
16		38	45	22.507.50.16.Z/140 ▼				
18		40	46	22.507.50.18.Z/140 ▼				
20		42	42	22.507.50.20.Z/140 ▼				
25		55	48	22.507.50.25.Z/140 ▼				
32		63	50	22.507.50.32.Z/140 ▼				

▲ UK stock - Generally x-stock for next day delivery

▼ European stock - Generally 2-3 days delivery (please check for lead times)

SLEEVES FOR YG-1 HYDRAULIC CHUCKS

P1041

OPEN TYPE - HK	CLOSED TYPE - HS	COOLANT JETS - HF
Open sleeves for non-through coolant cutting tools.	Closed sleeves for through coolant drills.	Sleeves with coolant grooves in the bore. Directs coolant jets directly to the cutting edge

SLEEVES FOR WTE HYDRAULIC CHUCKS

P1041

OPEN TYPE - Z	COOLANT JETS - KKB
With slits, for flexible diameter application. For through or non-through coolant tools.	Sleeves with coolant grooves in the bore. Directs coolant jets directly to the cutting edge



HYDRAULIC CHUCKS DIN 69871

1st Choice for Drilling, Reaming & High Speed Machining



SHORT & RIGID

- ▶ Balanced to G2.5 25,000RPM
- ▶ <3 micron run-out
- ▶ Made in South Korea



G2.5 25000 <3µm Run-out h6 DIN 69871 TIG P990 P1041

BALANCED 25,000RPM • G2.5

Taper	Dia.	Nose Dia.	Gauge Length	ORDER CODE	PRICE
SK40	12	32	50	SK40AD/B-HC12S-50 ▲	
	20	38	64.5	SK40AD/B-HC20S-64.5 ▲	
SK50	12	32	50	SK50AD/B-HC12S-50 ▲	
	20	37	64.5	SK50AD/B-HC20S-64.5 ▲	
	32	55	81	SK50AD/B-HC32S-81 ▲	

SHORT & RIGID

- ▶ Balanced to G2.5 25,000RPM
- ▶ <3 micron run-out
- ▶ Made in Germany



G2.5 25000 <3µm Run-out h6 DIN 69871 WTE MAPAL GROUP P990 P1041

BALANCED 25,000RPM • G2.5

Taper	Dia.	Nose Dia.	Gauge Length	ORDER CODE	PRICE
SK40	20	40.5	64.5	15.508.40.20.Z ▲	
SK50	32	72	81	15.508.50.32.Z ▲	

SLIM

- ▶ Balanced to G2.5 25,000RPM
- ▶ <3 micron run-out
- ▶ Made in South Korea



G2.5 25000 <3µm Run-out h6 DIN 69871 TIG P990 P1041

BALANCED 25,000RPM • G2.5

Taper	Dia.	Nose Dia.	Gauge Length	ORDER CODE	PRICE
SK40	6	26	80.5	SK40AD/B-HC6-80.5 ▲	
	8	28		SK40AD/B-HC8-80.5 ▲	
	10	30		SK40AD/B-HC10-80.5 ▲	
	12	32		SK40AD/B-HC12-80.5 ▲	
	16	38		SK40AD/B-HC16-80.5 ▲	
	20	42		SK40AD/B-HC20-80.5 ▲	
	25	50		SK40AD/B-HC25-80.5 ▲	
	32	60		110	SK40AD/B-HC32-110 ▲
SK50	6	26	80.5	SK50AD/B-HC6-80.5 ▲	
	8	28		SK50AD/B-HC8-80.5 ▲	
	10	30		SK50AD/B-HC10-80.5 ▲	
	12	32		SK50AD/B-HC12-80.5 ▲	
	16	38		SK50AD/B-HC16-80.5 ▲	
	20	42		SK50AD/B-HC20-80.5 ▲	

SLIM

- ▶ Balanced to G2.5 25,000RPM
- ▶ <3 micron run-out
- ▶ Made in Germany



G2.5 25000 <3µm Run-out h6 DIN 69871 WTE MAPAL GROUP P990 P1041

BALANCED 25,000RPM • G2.5

Taper	Dia.	Nose Dia.	Gauge Length	ORDER CODE	PRICE	
SK40	6	26	80.5	15.507.40.06.Z ▼		
	8	28		15.507.40.08.Z ▼		
	10	30		15.507.40.10.Z ▼		
	12	32		15.507.40.12.Z ▼		
	14	34		15.507.40.14.Z ▼		
	16	38		15.507.40.16.Z ▼		
	18	40		15.507.40.18.Z ▼		
	20	42		15.507.40.20.Z ▼		
	25	55		15.507.40.25.Z ▼		
	32	63		15.507.40.32.Z ▼		
SK50	6	26	80.5	15.507.50.06.Z ▼		
	8	28		15.507.50.08.Z ▼		
	10	30		15.507.50.10.Z ▼		
	12	32		15.507.50.12.Z ▼		
	14	34		15.507.50.14.Z ▼		
	16	38		15.507.50.16.Z ▼		
	18	40		15.507.50.18.Z ▼		
	20	42		15.507.50.20.Z ▼		
	25	55		100	15.507.50.25.Z ▼	
	32	63		100	15.507.50.32.Z ▼	

▲ UK stock - Generally x-stock for next day delivery ▼ European stock - Generally 2-3 days delivery (please check for lead times)

Detailed dimensions available at cutwel.co.uk. Alternatively contact our sales team for a copy of the technical information.

HYDRAULIC CHUCKS DIN 69871

1st Choice for Drilling, Reaming & High Speed Machining



ULTRA SHORT

- ▶ Balanced to G2.5 25,000RPM
- ▶ <3 micron run-out
- ▶ Designed for extra long drills
- ▶ Made in South Korea



ULTRA SHORT

- ▶ Balanced to G2.5 25,000RPM
- ▶ <3 micron run-out
- ▶ Designed for extra long drills
- ▶ Made in Germany



BALANCED 25,000RPM • G2.5

Taper	Dia	Nose Dia.	Gauge Length	ORDER CODE	PRICE
SK40	20	48	24.6	SK40-HC20-24.6 ▲	
SK50	32	70.5	30.9	SK50-HC32-30.9 ▲	

BALANCED 25,000RPM • G2.5

Taper	Dia	Nose Dia.	Gauge Length	ORDER CODE	PRICE
SK40	20	32	24.5	15.501.40.20.Z ▼	

LONG, SLIM & TAPERED

- ▶ Balanced to G2.5 25,000RPM
- ▶ <3 micron run-out
- ▶ 3° taper (per side), ideal for moulds
- ▶ Made in South Korea



LONG & NARROW

- ▶ Balanced to G2.5 25,000RPM
- ▶ <3 micron run-out
- ▶ Made in Germany



BALANCED 25,000RPM • G2.5

Taper	Dia.	Nose Dia.	Taper Length	Gauge Length	ORDER CODE	PRICE
SK40	6	20	70	120	SK40AD/B-HMC6-120 ▲	
			100	150	SK40AD/B-HMC6-150 ▲	
	8	22	70	120	SK40AD/B-HMC8-120 ▲	
			100	150	SK40AD/B-HMC8-150 ▲	
	10	24	70	120	SK40AD/B-HMC10-120 ▲	
			100	150	SK40AD/B-HMC10-150 ▲	
	12	25	70	120	SK40AD/B-HMC12-120 ▲	
			100	150	SK40AD/B-HMC12-150 ▲	
	16	32	70	120	SK40AD/B-HMC16-120 ▲	
			100	150	SK40AD/B-HMC16-150 ▲	
	20	34	70	120	SK40AD/B-HMC20-120 ▲	
			100	150	SK40AD/B-HMC20-150 ▲	

BALANCED 25,000RPM • G2.5

Taper	Dia	Nose Dia.	Nose Length	Gauge Length	ORDER CODE	PRICE		
SK40	6	26	29	110	15.507.40.06.Z/110 ▲			
	8	28	30		15.507.40.08.Z/110 ▲			
	10	30	35		15.507.40.10.Z/110 ▲			
	12	32	40		15.507.40.12.Z/110 ▲			
	14	34	40		15.507.40.14.Z/110 ▲			
	16	38	45		15.507.40.16.Z/110 ▲			
	18	40	46		15.507.40.18.Z/110 ▲			
	20	42	47		15.507.40.20.Z/110 ▲			
	25	55	28		15.507.40.25.Z/110 ▲			
	32	63	59		15.507.40.32.Z/110 ▲			
	SK50	6	26		29	110	15.507.50.06.Z/110 ▲	
		8	28		30		15.507.50.08.Z/110 ▲	
10		30	35	15.507.50.10.Z/110 ▲				
12		32	40	15.507.50.12.Z/110 ▲				
14		34	40	15.507.50.14.Z/110 ▲				
16		38	45	15.507.50.16.Z/110 ▲				
18		40	46	15.507.50.18.Z/110 ▲				
20		42	42	15.507.50.20.Z/110 ▲				
25		55	48	15.507.50.25.Z/110 ▲				
32		63	61	15.507.50.32.Z/110 ▲				

▲ UK stock - Generally x-stock for next day delivery ▼ European stock - Generally 2-3 days delivery (please check for lead times)

SLEEVES FOR YG-1 HYDRAULIC CHUCKS

P1041

OPEN TYPE - HK	CLOSED TYPE - HS	COOLANT JETS - HF
Open sleeves for non-through coolant cutting tools.	Closed sleeves for through coolant drills.	Sleeves with coolant grooves in the bore. Directs coolant jets directly to the cutting edge

SLEEVES FOR WTE HYDRAULIC CHUCKS

P1041

OPEN TYPE - Z	COOLANT JETS - KKB
With slits, for flexible diameter application. For through or non-through coolant tools.	Sleeves with coolant grooves in the bore. Directs coolant jets directly to the cutting edge



HYDRAULIC CHUCKS HSK-A

1st Choice for Drilling, Reaming & High Speed Machining



SHORT & RIGID

- ▶ Balanced to G2.5 25,000RPM
- ▶ <3 micron run-out
- ▶ Made in South Korea



P1041



BALANCED 25,000RPM • G2.5

Taper	Dia.	Nose Dia.	Gauge Length	ORDER CODE	PRICE
HSK63A	12	32	80	HSK63A-HC12S-80	▲
	20	38		HSK63A-HC20S-80	▲

SLIM

- ▶ Balanced to G2.5 25,000RPM
- ▶ <3 micron run-out
- ▶ Made in South Korea



P1041



BALANCED 25,000RPM • G2.5

Taper	Dia.	Nose Dia.	Gauge Length	ORDER CODE	PRICE
HSK63A	6	26	70	HSK63A-HC6-70	▲
	8	28	70	HSK63A-HC8-70	▲
	10	30	80	HSK63A-HC10-80	▲
	12	32	85	HSK63A-HC12-85	▲
	14	34	85	HSK63A-HC14-85	▲
	16	38	90	HSK63A-HC16-90	▲
	18	40	90	HSK63A-HC18-90	▲
	20	42	90	HSK63A-HC20-90	▲
HSK100A	25	50	120	HSK63A-HC25-120	▲
	32	60	125	HSK63A-HC32-125	▲
	6	26	75	HSK100A-HC6-75	▲
	8	28	75	HSK100A-HC8-75	▲
	10	30	90	HSK100A-HC10-90	▲
	12	32	95	HSK100A-HC12-95	▲
	14	34	95	HSK100A-HC14-95	▲
	16	38	100	HSK100A-HC16-100	▲
HSK100A	18	40	100	HSK100A-HC18-100	▲
	20	42	105	HSK100A-HC20-105	▲
	25	50	110	HSK100A-HC25-110	▲
	32	60	110	HSK100A-HC32-110	▲

COOLANT TUBES & KEYS HSK-A

- ▶ For through coolant supply on HSK tool holders (sold separately)

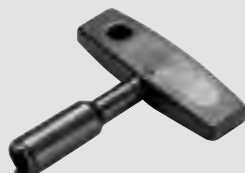

	HSK50-A	HSK63-A	HSK100-A
COOLANT TUBE	950APR01	963APR01	910APR01
COOLANT TUBE KEY	950CHVAR	963CHVAR	910CHVAR

SHORT & RIGID

- ▶ Balanced to G2.5 25,000RPM
- ▶ <3 micron run-out
- ▶ Made in Germany



P1041



BALANCED 25,000RPM • G2.5

Taper	Dia.	Nose Dia.	Gauge Length	ORDER CODE	PRICE
HSK63A	20	51.5	80	16.508.63.20.Z	▲

SLIM

- ▶ Balanced to G2.5 25,000RPM
- ▶ <3 micron run-out
- ▶ Made in Germany



P1041



BALANCED 25,000RPM • G2.5

Taper	Dia.	Nose Dia.	Gauge Length	ORDER CODE	PRICE
HSK50A	6	26	70	16.507.50.06.Z	▼
	8	28	70	16.507.50.08.Z	▼
	10	30	75	16.507.50.10.Z	▼
	12	32	85	16.507.50.12.Z	▼
	14	34	85	16.507.50.14.Z	▼
	16	38	90	16.507.50.16.Z	▼
	18	40	90	16.507.50.18.Z	▼
	20	42	90	16.507.50.20.Z	▼
HSK63A	6	26	70	16.507.63.06.Z	▼
	8	28	70	16.507.63.08.Z	▼
	10	30	80	16.507.63.10.Z	▼
	12	32	85	16.507.63.12.Z	▼
	14	34	85	16.507.63.14.Z	▼
	16	38	90	16.507.63.16.Z	▼
	18	40	90	16.507.63.18.Z	▼
	20	42	90	16.507.63.20.Z	▼
HSK100A	25	57	120	16.507.63.25.Z	▼
	32	63	125	16.507.63.32.Z	▼
	6	26	75	16.507.100.06.Z	▼
	8	28	75	16.507.100.08.Z	▼
	10	30	90	16.507.100.10.Z	▼
	12	32	95	16.507.100.12.Z	▼
	14	34	95	16.507.100.14.Z	▼
	16	38	100	16.507.100.16.Z	▼
	18	40	100	16.507.100.18.Z	▼
	20	42	105	16.507.100.20.Z	▼
	25	57	110	16.507.100.25.Z	▼
	32	63	110	16.507.100.32.Z	▼

▲ UK stock - Generally x-stock for next day delivery

▼ European stock - Generally 2-3 days delivery (please check for lead times)

Detailed dimensions available at cutwel.co.uk. Alternatively contact our sales team for a copy of the technical information.



HYDRAULIC CHUCKS HSK-A

1st Choice for Drilling, Reaming & High Speed Machining



SLIM & TAPERED

- ▶ Balanced to G2.5 25,000RPM
- ▶ <3 micron run-out
- ▶ 3° taper (per side), ideal for moulds
- ▶ Made in South Korea



P1041



LONG & NARROW

- ▶ Balanced to G2.5 25,000RPM
- ▶ <3 micron run-out
- ▶ Made in Germany



P990 P1041



BALANCED 25,000RPM • G2.5

Taper	Dia.	Nose Dia.	Taper Length	Gauge Length	ORDER CODE	PRICE
HSK63A	6	20	90	145	HSK63A-HMC6-145 ▲	
	8	22			HSK63A-HMC8-145 ▲	
	10	24			HSK63A-HMC10-145 ▲	
	12	25			HSK63A-HMC12-145 ▲	
	16	32			HSK63A-HMC16-145 ▲	
	20	34			HSK63A-HMC20-145 ▲	

BALANCED 25,000RPM • G2.5

Taper	Dia.	Nose Dia.	Nose Length	Gauge Length	ORDER CODE	PRICE
HSK63A	6	26	73	120	16.507.63.06.Z/120 ▼	
			103	150	16.507.63.06.Z/150 ▼	
			153	200	16.507.63.06.Z/200 ▼	
			74	120	16.507.63.08.Z/120 ▼	
			104	150	16.507.63.08.Z/150 ▼	
			154	200	16.507.63.08.Z/200 ▼	
	8	28	74	120	16.507.63.10.Z/120 ▼	
			104	150	16.507.63.10.Z/150 ▼	
			154	200	16.507.63.10.Z/200 ▼	
			75	120	16.507.63.12.Z/120 ▼	
			105	150	16.507.63.12.Z/150 ▼	
			155	200	16.507.63.12.Z/200 ▼	
	10	30	75	120	16.507.63.14.Z/120 ▼	
			105	150	16.507.63.14.Z/150 ▼	
			155	200	16.507.63.14.Z/200 ▼	
			76	120	16.507.63.16.Z/120 ▼	
			106	150	16.507.63.16.Z/150 ▼	
			156	200	16.507.63.16.Z/200 ▼	
	12	32	77	120	16.507.63.18.Z/120 ▼	
			107	150	16.507.63.18.Z/150 ▼	
			157	200	16.507.63.18.Z/200 ▼	
			78	120	16.507.63.20.Z/120 ▼	
			108	150	16.507.63.20.Z/150 ▼	
			158	200	16.507.63.20.Z/200 ▼	

TOOL TROLLEYS

- ▶ Compact or heavy duty options
- ▶ Supplied with 6 sets of tool carriers
- ▶ 10 year guarantee
- ▶ Optional shelf for the heavy duty trolley



Compact Trolley

Heavy Duty Trolley

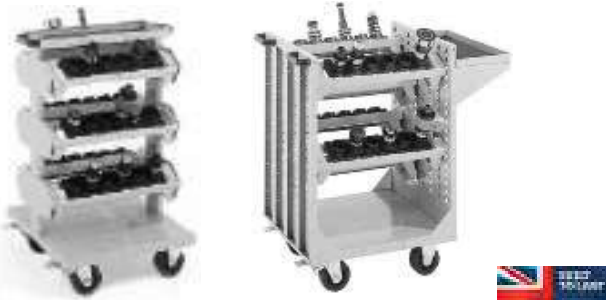

TAPER	No. Tool Pots	ORDER CODE	PRICE
COMPACT TROLLEY			
ISO/SK/BT 40	36	CPTROLLEY-ISO40 ▼	
ISO/SK/BT 50	30	CPTROLLEY-ISO50 ▼	
HSK 63A	36	CPTROLLEY-HSK63 ▼	
HSK 100A	30	CPTROLLEY-HSK100 ▼	
Capto C6	36	CPTROLLEY-C6 ▼	
HEAVY DUTY TROLLEY			
ISO/SK/BT 40	36	HDTROLLEY-ISO40 ▼	
ISO/SK/BT 50	30	HDTROLLEY-ISO50 ▼	
HSK 63A	36	HDTROLLEY-HSK63 ▼	
HSK 100A	30	HDTROLLEY-HSK100 ▼	
Capto C6	36	HDTROLLEY-C6 ▼	
End Shelf	-	12102084.16 ▼	

▲ UK stock - Generally x-stock for next day delivery ▼ European stock - Generally 2-3 days delivery (please check for lead times)

COOLANT TUBES & KEYS HSK-A

- ▶ For through coolant supply on HSK tool holders (sold separately)

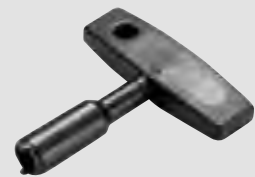

	HSK50-A	HSK63-A	HSK100-A
COOLANT TUBE	950APR01	963APR01	910APR01
COOLANT TUBE KEY	950CHVAR	963CHVAR	910CHVAR

SLEEVES FOR YG-1 HYDRAULIC CHUCKS

P1041

OPEN TYPE - HK	CLOSED TYPE - HS	COOLANT JETS - HF
Open sleeves for non-through coolant cutting tools.	Closed sleeves for through coolant drills.	Sleeves with coolant grooves in the bore. Directs coolant jets directly to the cutting edge

SLEEVES FOR WTE HYDRAULIC CHUCKS

P1041

OPEN TYPE - Z	COOLANT JETS - KKB
With slits, for flexible diameter application. For through or non-through coolant tools.	Sleeves with coolant grooves in the bore. Directs coolant jets directly to the cutting edge



HYDRAULIC CHUCKS HSK-E, HSK-F & DOUBLE CONTACT

1st Choice for Drilling, Reaming & High Speed Machining



SLIM HSK-E

- ▶ Balanced to G2.5 25,000RPM
- ▶ <3 micron run-out
- ▶ Made in Germany



P1041



SLIM HSK-F

- ▶ Balanced to G2.5 25,000RPM
- ▶ <3 micron run-out
- ▶ Made in Germany



P1041



BALANCED 25,000RPM • G2.5

Taper	Dia.	Nose Dia.	Gauge Length	ORDER CODE	PRICE
HSK40E	6	26	70	18.507.40.06.Z ▲	
	8	28	70	18.507.40.08.Z ▲	
	10	30	75	18.507.40.10.Z ▲	
	12	32	80	18.507.40.12.Z ▲	
HSK50E	6	26	70	18.507.50.06.Z ▲	
	8	28	70	18.507.50.08.Z ▲	
	10	30	75	18.507.50.10.Z ▲	
	12	32	85	18.507.50.12.Z ▲	
	14	34	85	18.507.50.14.Z ▲	
	16	38	90	18.507.50.16.Z ▲	
	18	40	90	18.507.50.18.Z ▲	
	20	42	90	18.507.50.20.Z ▲	

BALANCED 25,000RPM • G2.5

Taper	Dia.	Nose Dia.	Gauge Length	ORDER CODE	PRICE
HSK63F	6	26	70	17.507.63.06 ▲	
	8	28	70	17.507.63.08 ▲	
	10	30	80	17.507.63.10 ▲	
	12	32	85	17.507.63.12 ▲	
	14	34	85	17.507.63.14 ▲	
	16	38	90	17.507.63.16 ▲	
	18	40	90	17.507.63.18 ▲	
	20	42	90	17.507.63.20 ▲	
	25	57	120	17.507.63.25 ▲	

SLIM CBT DOUBLE CONTACT

- ▶ Balanced to G2.5 25,000RPM
- ▶ <3 micron run-out
- ▶ Made in South Korea



DOUBLE CONTACT

P990 P1041



HYDRAULIC CHUCK EXTENSION

- ▶ Balanced to G2.5 25,000RPM
- ▶ <3 micron run-out
- ▶ Made in Germany



BALANCED 25,000RPM • G2.5

Taper	Dia.	Nose Dia.	Gauge Length	ORDER CODE	PRICE
CBT40	6	26	90	CBT40-HC6-90 ▲	
	8	28	90	CBT40-HC8-90 ▲	
	10	30	90	CBT40-HC10-90 ▲	
	12	32	90	CBT40-HC12-90 ▲	
	16	38	90	CBT40-HC16-90 ▲	
	20	42	90	CBT40-HC20-90 ▲	
	25	50	100	CBT40-HC25-100 ▲	
	32	60	105	CBT40-HC32-105 ▲	

BALANCED 25,000RPM • G2.5

Shank	Clamp Dia.	Nose Dia.	Head Length	Overall Length	ORDER CODE	PRICE
20	12	25	100	150	40.557.20.12.Z ▲	
	20	31.5			40.557.20.20.Z ▲	
32	20	31.5	90	150	40.557.32.20.Z ▲	
				200	40.557.32.20.Z/200 ▲	

▲ UK stock - Generally x-stock for next day delivery

▼ European stock - Generally 2-3 days delivery (please check for lead times)

Detailed dimensions available at cutwel.co.uk. Alternatively contact our sales team for a copy of the technical information.

COOLANT TUBES & KEYS HSK-E

- ▶ For through coolant supply on HSK tool holders (sold separately)



	HSK40-E	HSK50-E	HSK63-E
COOLANT TUBE	950APR02	950APR01	963APR01
COOLANT TUBE KEY	816-204022	950CHVAR	963CHVAR

COOLANT TUBES & KEYS HSK-F

- ▶ For through coolant supply on HSK tool holders (sold separately)



	HSK50-F	HSK63-F
COOLANT TUBE	950APR02	950APR01
COOLANT TUBE KEY	816-204022	950CHVAR



HYDRAULIC CHUCKS SLEEVES

1st Choice for Drilling, Reaming & High Speed Machining

SLEEVES FOR YG-1 HYDRAULIC CHUCKS

OPEN TYPE

Open sleeves for non-through coolant cutting tools.

CLOSED TYPE

Closed sleeves for through coolant drills.

COOLANT JETS

Sleeves with coolant grooves in the bore. Directs coolant jets directly to the cutting edge



Sleeve Dia.	Inside Dia.	HK SERIES		HS SERIES		HF SERIES	
		ORDER CODE	PRICE	ORDER CODE	PRICE	ORDER CODE	PRICE
12	3	HK12-3	£58.58	HS12-3	£62.84	HF12-3	
	4	HK12-4	£58.58	HS12-4	£62.84	HF12-4	
	5	HK12-5	£58.58	HS12-5	£62.84	HF12-5	
	6	HK12-6	£58.58	HS12-6	£62.84	HF12-6	
	7	HK12-7	£58.58	HS12-7	£62.84	-	
	8	HK12-8	£58.58	HS12-8	£62.84	HF12-8	
20	3	HK20-3	£52.19	HS20-3	£62.84	HF20-3	
	4	HK20-4	£52.19	HS20-4	£62.84	HF20-4	
	5	HK20-5	£52.19	HS20-5	£62.84	HF20-5	
	6	HK20-6	£52.19	HS20-6	£62.84	HF20-6	
	7	HK20-7	£52.19	HS20-7	£62.84	-	
	8	HK20-8	£52.19	HS20-8	£62.84	HF20-8	
	9	HK20-9	£52.19	HS20-9	£62.84	-	
	10	HK20-10	£52.19	HS20-10	£62.84	HF20-10	
	11	HK20-11	£52.19	HS20-11	£62.84	-	
	12	HK20-12	£52.19	HS20-12	£62.84	HF20-12	
32	14	HK32-14	£55.38	HS32-14	£62.84	HF32-14	
	16	HK32-16	£55.38	HS32-16	£62.84	HF32-16	
	18	HK32-18	£55.38	HS32-18	£62.84	HF32-18	
	20	HK32-20	£55.38	HS32-20	£62.84	HF32-20	
	25	HK32-25	£55.38	HS32-25	£62.84	HF32-25	

SLEEVES FOR WTE HYDRAULIC CHUCKS

CLOSED TYPE

With slits, for flexible diameter application. For through coolant or non-through coolant tools.

COOLANT JETS

Sleeves with coolant grooves in the bore. Directs coolant jets directly to the cutting edge



Sleeve Dia.	Inside Dia.	Z SERIES		KKB SERIES	
		ORDER CODE	PRICE	ORDER CODE	PRICE
12	1	40.456.12.01.Z	£200.97	-	
	1.5	40.456.12.015.Z	£200.97	-	
	2	40.456.12.02.Z	£200.97	-	
	2.5	40.456.12.025.Z	£200.97	-	
	3	40.456.12.03.Z	£102.85	40.456.12.03.KKB	
	4	40.456.12.04.Z	£87.48	40.456.12.04.KKB	
	5	40.456.12.05.Z	£87.48	40.456.12.05.KKB	
	6	40.456.12.06.Z	£81.57	40.456.12.06.KKB	
	7	40.456.12.07.Z	£87.48	-	
	8	40.456.12.08.Z	£81.57	40.456.12.08.KKB	
20	9	40.456.12.09.Z	£87.48	-	
	10	40.456.12.10.Z	£81.57	-	
	3	40.456.20.03.Z	£93.39	40.456.20.03.KKB	
	4	40.456.20.04.Z	£86.30	40.456.20.04.KKB	
	5	40.456.20.05.Z	£86.30	40.456.20.05.KKB	
	6	40.456.20.06.Z	£79.20	40.456.20.06.KKB	
	7	40.456.20.07.Z	£86.30	-	
	8	40.456.20.08.Z	£79.20	40.456.20.08.KKB	
	9	40.456.20.09.Z	£86.30	-	
	10	40.456.20.10.Z	£79.20	40.456.20.10.KKB	
	11	40.456.20.11.Z	£86.30	-	
	12	40.456.20.12.Z	£79.20	40.456.20.12.KKB	
	13	40.456.20.13.Z	£128.85	-	
	14	40.456.20.14.Z	£79.20	40.456.20.14.KKB	
	15	40.456.20.15.Z	£130.04	-	
	16	40.456.20.16.Z	£79.20	40.456.20.16.KKB	
25	3	40.456.25.03.Z	£109.94	-	
	4	40.456.25.04.Z	£100.48	-	
	5	40.456.25.05.Z	£100.48	-	
	6	40.456.25.06.Z	£100.48	-	
	7	40.456.25.07.Z	£88.66	-	
	8	40.456.25.08.Z	£88.66	-	
	9	40.456.25.09.Z	£88.66	-	
	10	40.456.25.10.Z	£88.66	-	
	12	40.456.25.12.Z	£88.66	-	
	14	40.456.25.14.Z	£88.66	-	
32	16	40.456.25.16.Z	£88.66	-	
	18	40.456.25.18.Z	£88.66	-	
	20	40.456.25.20.Z	£88.66	-	
	6	40.456.32.06.Z	£101.66	40.456.32.06.KKB	
	7	40.456.32.07.Z	£101.66	-	
	8	40.456.32.08.Z	£101.66	40.456.32.08.KKB	
	9	40.456.32.09.Z	£101.66	-	
	10	40.456.32.10.Z	£101.66	40.456.32.10.KKB	
	11	40.456.32.11.Z	£147.77	-	
	12	40.456.32.12.Z	£96.94	40.456.32.12.KKB	
	13	40.456.32.13.Z	£147.77	-	
	14	40.456.32.14.Z	£96.94	40.456.32.14.KKB	
	15	40.456.32.15.Z	£147.77	-	
	16	40.456.32.16.Z	£96.94	40.456.32.16.KKB	
17	40.456.32.17.Z	£147.77	-		
18	40.456.32.18.Z	£96.94	40.456.32.18.KKB		
19	40.456.32.19.Z	£147.77	-		
20	40.456.32.20.Z	£96.94	40.456.32.20.KKB		
22	40.456.32.22.Z	£147.77	-		
25	40.456.32.25.Z	£96.94	40.456.32.25.KKB		



WTE HPH - HIGH PERFORMANCE HOLDERS



FEATURES

- Hydraulic clamping
- Choice of 3 nose geometries
- Made in Germany
- Clamping forces <890kN (higher than shrink chucks)
- 3 microns run-out

BENEFITS

- Up to 40% more cutting tool life than shrink chucks
- Reliable clamping at temperatures up to 170 °C
- Optimum radial run-out accuracy of 3µm with a projection length of 2.5 x D
- Better surface finish with longer tool life due to excellent dampening properties

HPH High Performance Holders,
The Holder For ULTRA-HIGH
Metal Removal Rates

Ideal For Extreme Roughing to Fine Finishing in
ALL MATERIALS.

WTE HPH holders are the first choice for HPC milling. They offer extreme clamping forces and vibration damping qualities-enabling the highest performance from your cutting tools & the longest tool life possible.

The HPH 3° Multi High Precision Slim Hydraulic Holders are a revolution in tool holding technology they have a 3° taper, so can be used in applications previously only possible with shrink fit chucks.



CONTENTS

BT MAS

BT30, BT40, BT50.....P1044

DIN 69871

SK40, SK50.....P1045

HSK-A

HSK63-A, HSK100-A.....P1046

HPH HIGH PERFORMANCE HOLDER SHORT & HEAVY

- Clamping diameters from 3-32mm (direct clamping in holder 12-32mm, clamping with sleeves 3-25mm)

WTE
MAPAL GROUP

Made in Germany

Available with resealable coolant bores (KKB type)



$3\mu\text{m}$
Run-out

G2.5
25000

TRANSFERABLE TORQUES WITH DIRECT CLAMPING TORQUE FIGURES IN NM

Clamping Diameter	6	8	10	12	14	16	18	20	25	32
Minimum Clamping Depth	27	27	31	36	36	39	39	41	47	51
Transferable torque (minimum value h6)	30	50	100	150	210	280	360	550	650	800
Transferable torque (maximum value h6)	40	65	135	190	280	380	450	650	750	890

HPH 3° MULTI HIGH PRECISION SLIM HYDRAULIC HOLDER

WITH A 3° TAPER FOR A HYDRAULIC TOOL HOLDER AS SLIM AS A SHRINK FIT CHUCK!

- Reliable clamping at temperatures up to 120°C
- Clamping diameters from 3-20mm
- Optimum radial run-out accuracy of 3µm with a projection length of 2.5 x D
- Better surface finish with longer tool life
- Shorter set-up times and lower tool costs

WTE
MAPAL GROUP

Made in Germany



$3\mu\text{m}$
Run-out

G2.5
25000

1 3° Taper as Slim as a Shrink Fit Chuck



2 Thermal Stability up to 120°C



3 Optimal Radial Run-out $3\mu\text{m}$



4 Quick & Easy Tool Change



5 Flexible Clamping Range Using Reduction Sleeves



TRANSFERABLE TORQUES WITH DIRECT CLAMPING TORQUE FIGURES IN NM

Clamping Diameter	6	8	10	12
Minimum Clamping Depth	27	27	31	36
Transferable torque (minimum value h6)	20	35	65	110
Transferable torque (maximum value h6)	35	55	90	150





HPH HOLDERS BT MAS

The Ultimate High Performance Holders • BALANCED 25,000RPM • G2.5

SHORT & HEAVY

- ▶ The ultimate high rigidity holder (for use with sleeves)
- ▶ No holder failure due to hydraulic membrane overheating
- ▶ Hydraulic clamping with damping effect

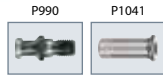

Taper	Clamping Diameter	Nose Diameter	Gauge Length	ORDER CODE	PRICE
STANDARD TYPE (THROUGH COOLANT)					
BT40	12	42	58	22.408.40.12.Z	▲
	20	49	72.5	22.408.40.20.Z	▲
	32	72	61	22.408.50.32.Z	▲
BT50	12	42	46	22.408.50.12.Z	▲
	20	49	51	22.408.50.20.Z	▲
	32	72	61	22.408.50.32.Z	▲
KKB TYPE (THROUGH COOLANT + RESEALABLE COOLANT BORES)					
BT40	12	42	58	22.408.40.12.KKB	▲
	20	49	72.5	22.408.40.20.KKB	▲

SHORT & NARROW

- ▶ The ultimate high rigidity holder (nominal dia. clamping)
- ▶ No holder failure due to hydraulic membrane overheating
- ▶ Hydraulic clamping with damping effect

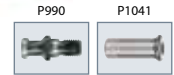

Taper	Clamping Diameter	Nose Diameter	Gauge Length	ORDER CODE	PRICE
BT40	6	32	80	22.407.40.06.Z	▲
	8	34	80	22.407.40.08.Z	▲
	10	36	85	22.407.40.10.Z	▲
	12	38	90	22.407.40.12.Z	▲
	14	40	90	22.407.40.14.Z	▼
	16	42	95	22.407.40.16.Z	▲
	18	44	95	22.407.40.18.Z	▼
	20	48	100	22.407.40.20.Z	▲
	25	57	110	22.407.40.25.Z	▲
	32	63	120	22.407.40.32.Z	▲

SHORT & HEAVY KIT

- ▶ Kit contains 1 x 20mm BT40 HPH holder + 5 reduction sleeves (16, 12, 10, 8 & 6mm)



Sleeves Included	ORDER CODE	PRICE
6, 8, 10, 12, 16	99.408.0003	▲ £491.19

LONG & ULTRA NARROW 3°

- ▶ No holder failure due to overheating of hydraulic membrane
- ▶ The perfect alternative to shrink fit
- ▶ Hydraulic clamping with damping effect
- ▶ Ultra slim nose profile of just 3mm per side



Taper	Clamping Diameter	Nose Diameter	Gauge Length	ORDER CODE	PRICE
BT30	3	10	85	22.404.30.03.Z/85	▼
	4	12		22.404.30.04.Z/85	▼
	5	13		22.404.30.05.Z/85	▼
	6	14		22.404.30.06.Z/85	▼
	8	16		22.404.30.08.Z/85	▼
	10	18		22.404.30.10.Z/85	▼
	12	20		22.404.30.12.Z/85	▼
	14	24		22.404.30.14.Z/85	▼
	16	26		22.404.30.16.Z/85	▼
	18	28		22.404.30.18.Z/85	▼
BT40	3	9	120	22.404.40.03.Z/120	▼
	4	10		22.404.40.04.Z/120	▼
	5	11		22.404.40.05.Z/120	▼
	6	12	120	22.404.40.06.Z/120	▼
		16	160	22.404.40.06.Z/160	▼
		200	22.404.40.06.Z/200	▼	
	8	14	120	22.404.40.08.Z/120	▼
		18	160	22.404.40.08.Z/160	▼
		200	22.404.40.08.Z/200	▲	
	10	16	120	22.404.40.10.Z/120	▼
		20	160	22.404.40.10.Z/160	▼
		200	22.404.40.10.Z/200	▼	
	12	18	120	22.404.40.12.Z/120	▼
		22	160	22.404.40.12.Z/160	▼
		200	22.404.40.12.Z/200	▼	
	14	22	120	22.404.40.14.Z/120	▼
		24		22.404.40.16.Z/120	▼
		26		22.404.40.18.Z/120	▼
28		22.404.40.20.Z/120		▼	

▲ UK stock - Generally x-stock for next day delivery ▼ European stock - Generally 2-3 days delivery (please check for lead times)

HPH HOLDERS DIN 69871

The Ultimate High Performance Holders • BALANCED 25,000RPM • G2.5

SHORT & HEAVY

- ▶ The ultimate high rigidity holder (for use with sleeves)
- ▶ No holder failure due to hydraulic membrane overheating
- ▶ Hydraulic clamping with damping effect

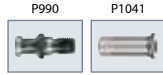

G2.5
25000

<3µm
Run-out

DIN
69871

Taper	Clamping Diameter	Nose Diameter	Gauge Length	ORDER CODE	PRICE
STANDARD TYPE (THROUGH COOLANT)					
SK40	12	42	50	15.408.40.12.Z	▲
	20	49	64.5	15.408.40.20.Z	▲
SK50	12	42	50	15.408.50.12.Z	▲
	20	49	64.5	15.408.50.20.Z	▲
	32	72	81	15.408.50.32.Z	▲
KKB TYPE (THROUGH COOLANT + RESEALABLE COOLANT BORES)					
SK40	12	42	50	15.408.40.12.KKB	▲
	16	46	64.5	15.408.40.16.KKB	▲
	20	49	64.5	15.408.40.20.KKB	▲

SHORT & NARROW

- ▶ The ultimate high rigidity holder (nominal dia. clamping)
- ▶ No holder failure due to hydraulic membrane overheating
- ▶ Hydraulic clamping with damping effect



G2.5
25000

<3µm
Run-out

DIN
69871

Taper	Clamping Diameter	Nose Diameter	Gauge Length	ORDER CODE	PRICE
SK40	6	32	75	15.407.40.06.Z	▼
	8	34	75	15.407.40.08.Z	▼
	10	36	80	15.407.40.10.Z	▼
	12	38	85	15.407.40.12.Z	▼
	14	40	85	15.407.40.14.Z	▼
	16	42	90	15.407.40.16.Z	▼
	18	44	90	15.407.40.18.Z	▼
	20	48	95	15.407.40.20.Z	▼
	25	57	110	15.407.40.25.Z	▼
	32	63	120	15.407.40.32.Z	▼

SHORT & HEAVY KIT

- ▶ Kit contains 1 x 20mm SK40 HPH holder + 5 reduction sleeves (16, 12, 10, 8 & 6mm)



P990

G2.5
25000

<3µm
Run-out

DIN
69871

Sleeves Included	ORDER CODE	PRICE
6, 8, 10, 12, 16	99.408.0002	▲ £491.19

LONG & ULTRA NARROW 3°

- ▶ No holder failure due to overheating of hydraulic membrane
- ▶ The perfect alternative to shrink fit
- ▶ Hydraulic clamping with damping effect
- ▶ Ultra slim nose profile of just 3mm per side



G2.5
25000

<3µm
Run-out

DIN
69871

Taper	Clamping Diameter	Nose Diameter	Gauge Length	ORDER CODE	PRICE
SK40	3	9	120	15.404.40.03.Z/120	▼
	4	10	120	15.404.40.04.Z/120	▼
	5	11	120	15.404.40.05.Z/120	▼
		12	120	15.404.40.06.Z/120	▼
	6	16	160	15.404.40.06.Z/160	▼
		16	200	15.404.40.06.Z/200	▼
	8	14	120	15.404.40.08.Z/120	▼
		18	160	15.404.40.08.Z/160	▼
	8	18	200	15.404.40.08.Z/200	▼
		10	16	120	15.404.40.10.Z/120
	10		20	160	15.404.40.10.Z/160
		10	20	200	15.404.40.10.Z/200
	12		18	120	15.404.40.12.Z/120
		12	22	160	15.404.40.12.Z/160
	12		22	200	15.404.40.12.Z/200
		14	22	120	15.404.40.14.Z/120
	16	24	120	15.404.40.16.Z/120	▼
	18	26	120	15.404.40.18.Z/120	▼
	20	28	120	15.404.40.20.Z/120	▼

▲ UK stock - Generally x-stock for next day delivery ▼ European stock - Generally 2-3 days delivery (please check for lead times)

HPH HOLDERS HSK-A

The Ultimate High Performance Holders • BALANCED 25,000RPM • G2.5

SHORT & HEAVY

- ▶ The ultimate high rigidity holder (for use with sleeves)
- ▶ No holder failure due to hydraulic membrane overheating
- ▶ Hydraulic clamping with damping effect



P1041



Taper	Clamping Diameter	Nose Diameter	Gauge Length	ORDER CODE	PRICE
STANDARD TYPE (THROUGH COOLANT)					
HSK63A	12	42	80	16.408.63.12.Z	▲
	20	49	80	16.408.63.20.Z	▲
HSK100A	12	42	85	16.408.100.12.Z	▼
	20	49	85	16.408.100.20.Z	▲
	32	68	100	16.408.100.32.Z	▼
KKB TYPE (THROUGH COOLANT + RESEALABLE COOLANT BORES)					
HSK63A	12	42	80	16.408.63.12.KKB	▲
	16	46	80	16.408.63.16.KKB	▲
	20	49	80	16.408.63.20.KKB	▲

SHORT & HEAVY KIT

- ▶ Kit contains 1 x 20mm HSK63A HPH holder + 5 reduction sleeves (16, 12, 10, 8 & 6mm)



Sleeves Included	ORDER CODE	OFFER PRICE
6, 8, 10, 12, 16	99.408.0001	▲

SHORT & NARROW

- ▶ The ultimate high rigidity holder (nominal dia. clamping)
- ▶ No holder failure due to hydraulic membrane overheating
- ▶ Hydraulic clamping with damping effect



P1041



Taper	Clamping Diameter	Nose Diameter	Gauge Length	ORDER CODE	PRICE	
HSK63A	6	32	80	16.407.63.06.Z	▼	
	8	34	80	16.407.63.08.Z	▼	
	10	36	85	16.407.63.10.Z	▼	
	12	38	90	16.407.63.12.Z	▼	
	14	40	90	16.407.63.14.Z	▼	
	16	42	95	16.407.63.16.Z	▼	
	18	44	95	16.407.63.18.Z	▼	
	20	48	100	16.407.63.20.Z	▼	
	25	57	120	16.407.63.25.Z	▼	
	32	63	125	16.407.63.32.Z	▼	
	HSK100A	6	32	85	16.407.100.06.Z	▼
		8	34	85	16.407.100.08.Z	▼
10		36	90	16.407.100.10.Z	▼	
12		38	95	16.407.100.12.Z	▼	
14		40	95	16.407.100.14.Z	▼	
16		42	100	16.407.100.16.Z	▼	
18		44	100	16.407.100.18.Z	▼	
20		48	105	16.407.100.20.Z	▼	
25		57	115	16.407.100.25.Z	▼	
32		63	120	16.407.100.32.Z	▼	

COOLANT TUBES & KEYS HSK-A

- ▶ For through coolant supply on HSK tool holders (sold separately)



	HSK50-A	HSK63-A	HSK100-A
COOLANT TUBE	950APR01	963APR01	910APR01
COOLANT TUBE KEY	950CHVAR	963CHVAR	910CHVAR

▲ UK stock - Generally x-stock for next day delivery ▼ European stock - Generally 2-3 days delivery (please check for lead times)

HPH HOLDERS HSK-A

The Ultimate High Performance Holders • BALANCED 25,000RPM • G2.5

LONG & ULTRA NARROW 3°

- ▶ The perfect alternative to shrink fit
- ▶ No holder failure due to hydraulic membrane overheating
- ▶ Hydraulic clamping with damping effect
- ▶ Ultra slim nose profile of just 3mm per side



P1041



Taper	Clamping Diameter	Nose Diameter	Gauge Length	ORDER CODE	PRICE	
HSK63A	3	9	120	16.404.63.03.Z/120	▼	
	4	10		16.404.63.04.Z/120	▼	
	5	11		16.404.63.05.Z/120	▼	
	6	16	12	120	16.404.63.06.Z/120	▼
			16	160	16.404.63.06.Z/160	▼
		16	200	16.404.63.06.Z/200	▼	
	7	13	120	16.404.63.07.Z/120	▼	
	8	18	14	120	16.404.63.08.Z/120	▼
			18	160	16.404.63.08.Z/160	▼
		18	200	16.404.63.08.Z/200	▼	
	9	15	120	16.404.63.09.Z/120	▼	
	10	20	16	120	16.404.63.10.Z/120	▼
			16	160	16.404.63.10.Z/160	▼
		20	200	16.404.63.10.Z/200	▼	
	11	17	120	16.404.63.11.Z/120	▼	
	12	22	18	120	16.404.63.12.Z/120	▼
			18	160	16.404.63.12.Z/160	▼
		22	200	16.404.63.12.Z/200	▼	
	13	20	120	16.404.63.13.Z/120	▼	
	14	22		16.404.63.14.Z/120	▼	
16	24	16.404.63.16.Z/120		▼		
18	26	16.404.63.18.Z/120		▼		
20	28	16.404.63.20.Z/120		▼		
20	28	16.404.63.20.Z/120		▼		
HSK100A	3	9	120	16.404.100.03.Z/120	▼	
	4	10		16.404.100.04.Z/120	▼	
	5	11		16.404.100.05.Z/120	▼	
	6	12		16.404.100.06.Z/120	▼	
	7	13		16.404.100.07.Z/120	▼	
	8	14		16.404.100.08.Z/120	▼	
	9	15		16.404.100.09.Z/120	▼	
	10	16		16.404.100.10.Z/120	▼	
	11	17		16.404.100.11.Z/120	▼	
	12	18		16.404.100.12.Z/120	▼	
	13	20		16.404.100.13.Z/120	▼	
	14	22		16.404.100.14.Z/120	▼	
	16	24		16.404.100.16.Z/120	▼	
	18	26		16.404.100.18.Z/120	▼	
20	28	16.404.100.20.Z/120	▼			

▲ UK stock - Generally x-stock for next day delivery ▼ European stock - Generally 2-3 days delivery (please check for lead times)