

simturnGX

Strong, stable, versatile and precise are the 4 key advantages of Simturn GX.

The strong tool holders combined with precision insert pocket ensures highest machining stability, even in deep grooving applications providing high accuracy and long tool life with minimal vibration.

Inserts are available in 5 geometries for grooving, profiling, parting and external thread turning in ground or sintered type. All inserts are supplied in Simtek's ultra-high performance X800 grade which excels in performance machining of steel, stainless steel, cast iron and exotics.

Tool holders can clamp different width inserts, for example holders with SERIES G29.03 can hold 3mm and 4mm grooving or parting inserts as well as 1.0-2.5mm pitch thread turning inserts.

STRONG, STABLE, VERSATILE & PRECISE

INTERNAL & EXTERNAL MACHINING WITH CUTTING CONDITIONS

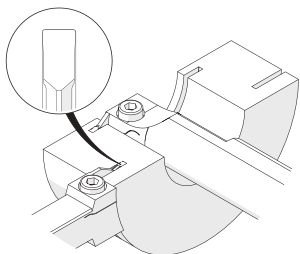

**GROOVING & PROFILING
SQUARE**

2-5mm wide inserts

Ground insert for high precision grooving

Sintered insert for best chip control in semi-roughing

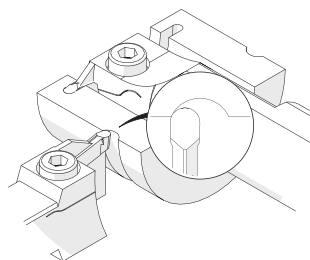

**GROOVING & PROFILING
FULL RADIUS**

2-5mm wide inserts

Ground insert for high precision grooving

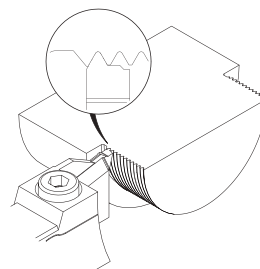

**EXTERNAL THREADING
ISO METRIC**

1-2.5mm pitch inserts

Ground full profile inserts

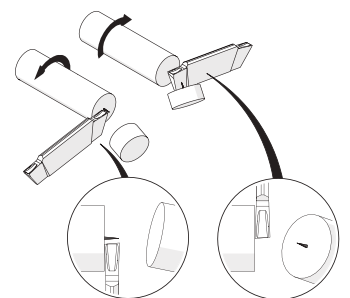

**PARTING OFF
RIGHT HAND**

2-4mm wide inserts

5° right hand angle ensures best performance and lightest cutting

SIMTURN GX EXTERNAL TOOL HOLDER STRAIGHT

- ▶ One holder can be used for multiple insert widths (e.g. Series G29.03 can hold 3-4mm wide inserts)
- ▶ Max cutting depth 26mm

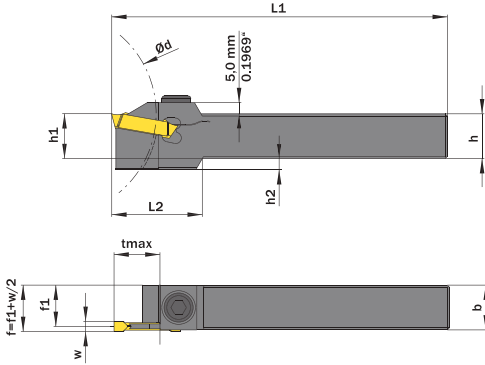

h	b	w _{min}	w _{max}	h1	h2	L1	L2	t _{max}	ORDER CODE	PRICE	SERIES
16	16	2	2.9	16	9	125	40	11	G10.1616.02 R/L		G29.02
16	16	2	2.9	16	9	125	42.5	26	G26.1616.02 R/L		
20	20	2	2.9	20	5	125	40	11	G10.2020.02 R/L		
20	20	2	2.9	20	5	125	42.5	26	G26.2020.02 R/L		
25	25	2	2.9	25	-	150	-	11	G10.2525.02 R/L		
25	25	2	2.9	25	-	150	-	26	G26.2525.02 R/L		
16	16	3	4	16	9	125	40	11	G10.1616.03 R/L		G29.03
16	16	3	4	16	9	125	42.5	26	G26.1616.03 R/L		
20	20	3	4	20	5	125	40	11	G10.2020.03 R/L		
20	20	3	4	20	5	125	42.5	26	G26.2020.03 R/L		
25	25	3	4	25	-	150	-	11	G10.2525.03 R/L		
25	25	3	4	25	-	150	-	26	G26.2525.03 R/L		
32	25	3	4	32	-	170	-	20	G18.3225.03 R/L		
32	25	3	4	32	-	170	-	26	G26.3225.03 R/L		
16	16	4	5.1	16	9	125	40	11	G10.1616.04 R/L		G29.04
20	20	4	5.1	20	5	125	40	11	G10.2020.04 R/L		
20	20	4	5.1	20	5	125	42.5	26	G26.2020.04 R/L		
25	25	4	5.1	25	-	150	-	11	G10.2525.04 R/L		
25	25	4	5.1	25	-	150	-	26	G26.2525.04 R/L		
32	25	4	5.1	32	-	170	-	20	G18.3225.04 R/L		
32	25	4	5.1	32	-	170	-	26	G26.3225.04 R/L		

SIMTURN GX EXTERNAL TOOL HOLDER CRANKED

- ▶ Designed for face grooving operations
- ▶ Max cutting depth 11mm

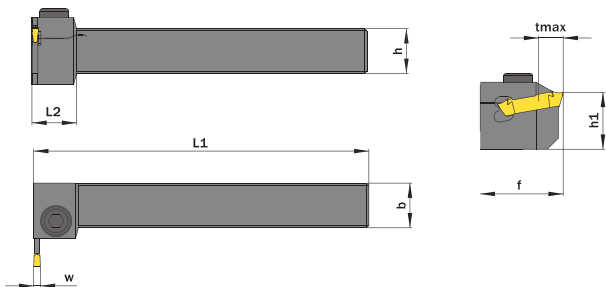

h	b	w _{min}	w _{max}	f	h1	L1	L2	t _{max}	ORDER CODE	PRICE	SERIES
20	20	3	4	37	25	125	20	11	G19.2020.03 R/L		G29.03
25	25	3	4	37	25	150	20	11	G19.2525.03 R/L		
20	20	4	5	37	25	125	20	11	G19.2020.04 R/L		G29.04
25	25	4	5	37	25	150	20	11	G19.2525.04 R/L		

SIMTURN GX INTERNAL TOOL HOLDER STEEL SHANK

- ▶ One holder can be used for multiple insert widths (e.g. Series G29.03 can hold 3-4mm wide inserts)
- ▶ Short & long length holders

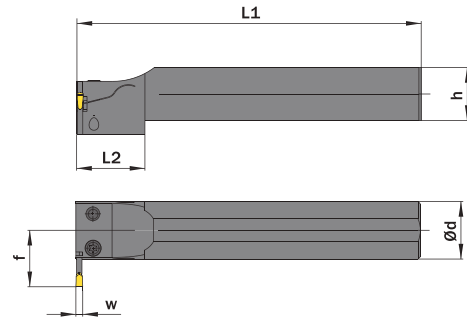

Ød	ØD Min Bore	w _{min}	w _{max}	f	h1	L1	L2	t _{max}	ORDER CODE	PRICE	SERIES
32	40	2	2.9	28.5	15	200	70	11	G14.0032.02 R/L		G29.02
25	38	3	4	27	11.5	150	-	8	G13.0025.03 R/L		G29.03
32	38	3	4	28	15	150	30	8	G13.0032.03 R/L		
32	40	3	4	28.5	15	200	70	8	G14.0032.03 R/L		
40	50	3	4	32	19	180	30	11.5	G13.0040.03 R/L		
40	50	3	4	32	19	250	80	11.5	G14.0040.03 R/L		
50	60	3	4	40.5	23.5	200	30	15	G13.0050.03 R/L		G29.04
50	60	3	4	40.5	23.5	250	100	15	G14.0050.03 R/L		
25	38	4	5.1	27	11.5	150	-	8	G13.0025.04 R/L		G29.04
32	38	4	5.1	28	15	150	30	8	G13.0032.04 R/L		
32	40	4	5.1	28.5	15	200	70	8	G14.0032.04 R/L		
40	50	4	5.1	32	19	180	30	11.5	G13.0040.04 R/L		
40	50	4	5.1	32	19	250	80	11.5	G14.0040.04 R/L		
50	60	4	5.1	40.5	23.5	200	30	15	G13.0050.04 R/L		
50	60	4	5.1	40.5	23.5	250	100	15	G14.0050.04 R/L		

SIMTURN GX INSERTS FOR GROOVING & PROFILING GRADIUM X800 COATED

- ▶ Excellent performance on steel, stainless, HRSA's and cast iron
- ▶ Geometries for grooving, profiling, parting & external threading

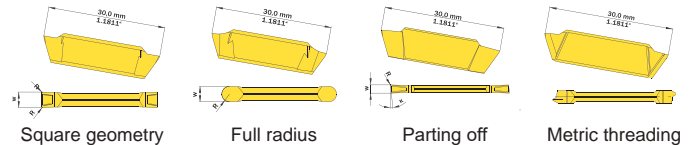

App.	W	R	PITCH	DESCRIPTION	ORDER CODE	1-4 PRICE EACH	5+ PRICE EACH	SERIES
Ground insert for high precision grooving & profiling	2	0.2	-	G29.0200.10 S	AH87X800			G29.02
	2.5	0.2	-	G29.0250.10 S	AG6SX800			
	3	0.2	-	G29.0300.10 S	ACA7X800			G29.03
	4	0.2	-	G29.0400.10 S	AES9X800			G29.03 / G29.04
	5	0.2	-	G29.0500.10 S	AFY3X800			G29.04
Sintered insert for best chip control	2	0.2	-	G29.0200.32 S	ABNMX800			G29.02
	2.5	0.2	-	G29.0250.32 S	AHMBX800			
	3	0.4	-	G29.0300.34 S	AN8AX800			G29.03
	4	0.4	-	G29.0400.34 S	AAE0X800			G29.03 / G29.04
	5	0.4	-	G29.0500.34 S	AN6EX800			G29.04
Full radius for CNC profiling	2	1	-	G29.0020.10 S	ADWNX800			G29.02
	3	1.5	-	G29.0030.15 S	ANAZX800			
	4	2	-	G29.0040.20 S	AK7NX800			G29.03
	5	2.5	-	G29.0050.25 S	ANTEX800			G29.03 / G29.04
Parting off (right hand 5° angle)	2	0.2	-	G29.5200.32 S R	AMW7X800			G29.02
	3	0.2	-	G29.5300.32 S R	AH07X800			
	4	0.2	-	G29.5400.32 S R	AB5FX800			G29.03
Metric ISO full profile external threading	-	-	1	G29.0610.02 S R	AF43X800			G29.03
	-	-	1.25	G29.0712.02 S R	AD39X800			
	-	-	1.5	G29.0915.02 S R	AEHBX800			
	-	-	1.75	G29.1017.02 S R	AMK1X800			
	-	-	2	G29.1220.02 S R	AAGPX800			
-	-	2.5	G29.1525.02 S R	AJVWX800				