

# MICRO UNIVERSAL CHUCKS

## Version 340

### Shank form SK as per ISO 7388-1

SK 30	_____	262
-------	-------	-----

### Shank form BT as per ISO 7388-2

BT 30	_____	262
-------	-------	-----

### Shank form HSK

HSK-A 32/40/50/63	_____	263
-------------------	-------	-----

HSK-E 25/32/40/50	_____	264
-------------------	-------	-----

### Cylindrical shank

Cylindrical shank	_____	265
-------------------	-------	-----

### Accessories

Accessories	_____	269
-------------	-------	-----

## Version 640

### Shank form SK as per ISO 7388-1

SK 30	_____	266
-------	-------	-----

### Shank form BT as per ISO 7388-2

BT 30	_____	266
-------	-------	-----

### Shank form HSK

HSK-A 32/40/50	_____	267
----------------	-------	-----

HSK-E 25/32/40	_____	268
----------------	-------	-----

### Cylindrical shank

Cylindrical shank	_____	269
-------------------	-------	-----

### Accessories

Accessories	_____	269
-------------	-------	-----

# MICRO Universal Chuck 340

ISO 7388-1, Form AD (prev. DIN 69871-AD)

ISO 7388-2 (JIS B6339) coolant supply as per ISO 7388-2, Form JD

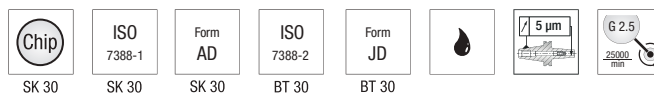
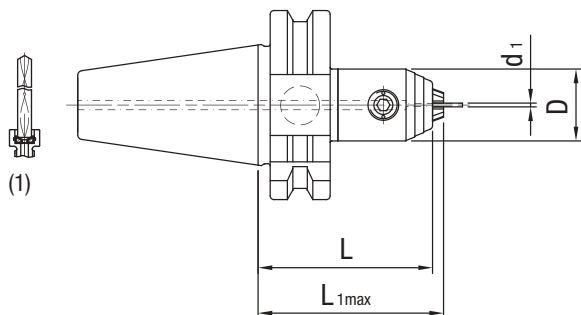

Nominal size Shank	WTE Norm	Clamping range	Dimensions			Weight [kg]	Order designation	Order No.
			$d_1$	D	L			
SK 30	WTE 03	0.2-3.4	19	45	48	0.41	15.236.30.03.Z	30439744
BT 30	WTE 03	0.2-3.4	19	48	51	0.47	22.236.30.03.Z	30439751

(1) WTE 03 sealing disk ( $\varnothing$  0.5 mm) included in scope of supply, for inner coolant drills  $\varnothing$  0.7-3.4 mm with smooth shank acc. to DIN 6535 Form HA.

# MICRO Universal Chuck 340

DIN 69893-A

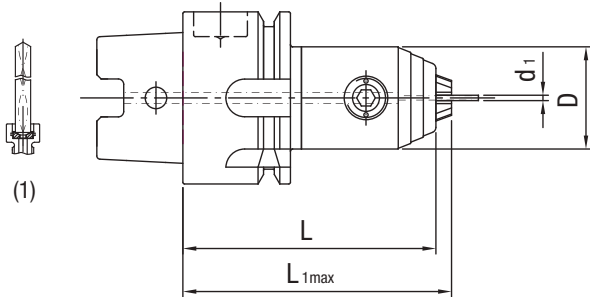

Nominal size HSK-A	WTE Norm	Clamping range	Dimensions			Weight [kg]	Order designation	Order No.
			$d_1$	D	L			
32	WTE 03	0.2-3.4	19	46	49	0.16	16.236.32.03.Z	30439728
40	WTE 03	0.2-3.4	19	46	49	0.24	16.236.40.03.Z	30439736
50	WTE 03	0.2-3.4	19	52	55	0.43	16.236.50.03.Z	30439739
63	WTE 03	0.2-3.4	19	52	55	0.7	16.236.63.03.Z	30633696

(1) WTE 03 sealing disk (ø 0.5 mm) included in scope of supply, for inner coolant drills ø 0.7-3.4 mm with smooth shank acc. to DIN 6535 Form HA.

# MICRO Universal Chuck 340

DIN 69893-E

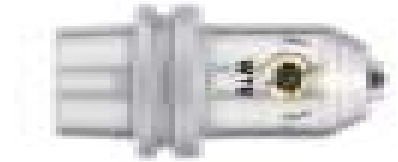
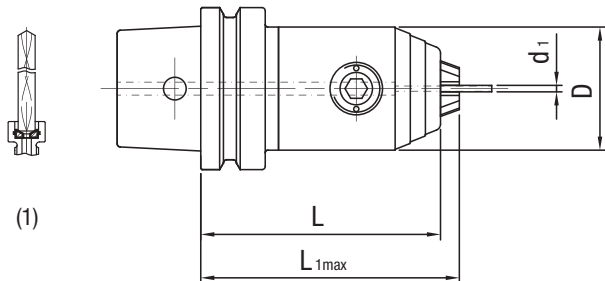

Nominal size HSK-E	WTE Norm	Clamping range	Dimensions			Weight [kg]	Order designation	Order No.
			d <sub>1</sub>	D	L			
25	WTE 03	0.2-3.4	19	37	40	0.1	18.236.25.03.Z	30439663
32	WTE 03	0.2-3.4	19	46	49	0.17	18.236.32.03.Z	30439686
40	WTE 03	0.2-3.4	19	46	49	0.25	18.236.40.03.Z	30439722
50	WTE 03	0.2-3.4	19	52	55	0.44	18.236.50.03.Z	30564786

(1) WTE 03 sealing disk (ø 0.5 mm) included in scope of supply, for inner coolant drills ø 0.7-3.4 mm with smooth shank acc. to DIN 6535 Form HA.

Dimensions in mm.

Custom designs available on request.

# MICRO Universal Chuck 340

With cylindrical shank, diameter 10 / 16 / 20 mm, for WTE Norm 03

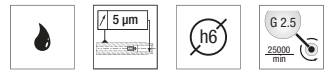
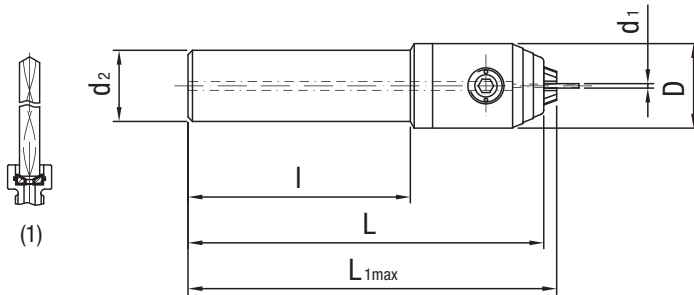

Nominal size Shank	WTE Norm	Clamp. range	Dimensions					Weight [kg]	Order designation	Order No.
			$d_1$	D	$d_2$	L	$L_1$ max.			
10	WTE 03	0.2-3.4	19	10	70	73	40	0.08	40.257.10.03.Z	30500299
10	WTE 03	0.2-3.4	19	10	100	103	70	0.09	40.257.10.03.Z/100	30500301
10	WTE 03	0.2-3.4	19	10	160	163	130	0.13	40.257.10.03.Z/160	30500302
16	WTE 03	0.2-3.4	19	16	80	83	50	0.13	40.257.16.03.Z	30439821
16	WTE 03	0.2-3.4	19	16	100	103	70	0.16	40.257.16.03.Z/100	30439832
16	WTE 03	0.2-3.4	19	16	160	163	130	0.26	40.257.16.03.Z/160	30439837
20	WTE 03	0.2-3.4	19	20	80	83	52	0.17	40.257.20.03.Z	30439755
20	WTE 03	0.2-3.4	19	20	100	103	72	0.21	40.257.20.03.Z/100	30439758
20	WTE 03	0.2-3.4	19	20	160	163	132	0.36	40.257.20.03.Z/160	30439763

(1) WTE 03 sealing disk ( $\varnothing$  0.5 mm) included in scope of supply, for inner coolant drills  $\varnothing$  0.7-3.4 mm with smooth shank acc. to DIN 6535 Form HA.

# MICRO Universal Chuck 640

ISO 7388-1, Form AD (prev. DIN 69871-AD)

ISO 7388-2 (JIS 6339) coolant supply as per ISO 7388-2, Form JD

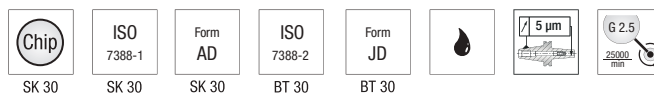
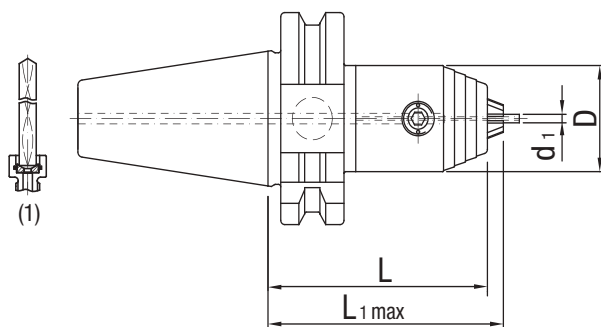

Nominal size Shank	WTE Norm	Clamping range	Dimensions			Weight [kg]	Order designation	Order No.
			$d_1$	D	L			
SK 30	WTE 06	0.2-6.4	25	55	59	0.8	15.266.30.06.Z	30564796
BT 30	WTE 06	0.2-6.4	25	58	62	0.9	22.266.30.06.Z	30564869

(1) WTE 06 sealing disk ( $\varnothing$  0.5 mm) included in scope of supply, for inner coolant drills  $\varnothing$  0.7-6.4 mm with smooth shank acc. to DIN 6535 Form HA.

# MICRO Universal Chuck 640

DIN 69893-A

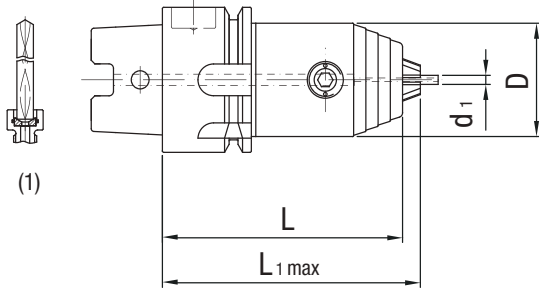

(1)



Nominal size HSK-A	WTE Norm	Clamping range	Dimensions			Weight [kg]	Order designation	Order No.
			d <sub>1</sub>	D	L			
32	WTE 06	0.2-6.4	25	54	58	0.3	16.266.32.06.Z	30564811
40	WTE 06	0.2-6.4	25	54	58	0.4	16.266.40.06.Z	30564819
50	WTE 06	0.2-6.4	25	61	65	0.4	16.266.50.06.Z	30564823

(1) WTE 06 sealing disk (ø 0.5 mm) included in scope of supply, for inner coolant drills ø 0.7-6.4 mm with smooth shank acc. to DIN 6535 Form HA.

# MICRO Universal Chuck 640

DIN 69893-E

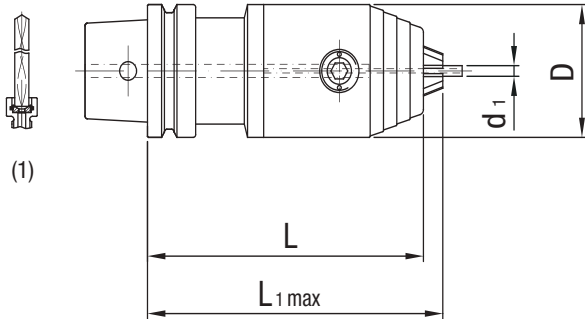

Nominal size HSK-E	WTE Norm	Clamping range	Dimensions			Weight [kg]	Order designation	Order No.
			d <sub>1</sub>	D	L			
25	WTE 06	0.2-6.4	25	60	64	0.3	18.266.25.06.Z	30564833
32	WTE 06	0.2-6.4	25	54	58	0.3	18.266.32.06.Z	30564839
40	WTE 06	0.2-6.4	25	54	58	0.4	18.266.40.06.Z	30564844

(1) WTE 06 sealing disk (ø 0.5 mm) included in scope of supply, for inner coolant drills ø 0.7-6.4 mm with smooth shank acc. to DIN 6535 Form HA.



# MICRO Universal Chuck 640

With cylindrical shank, diameter 16 / 20 mm, für WTE Norm 06

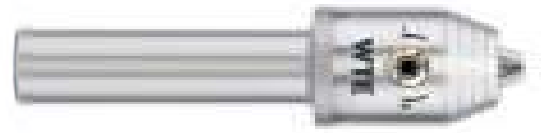
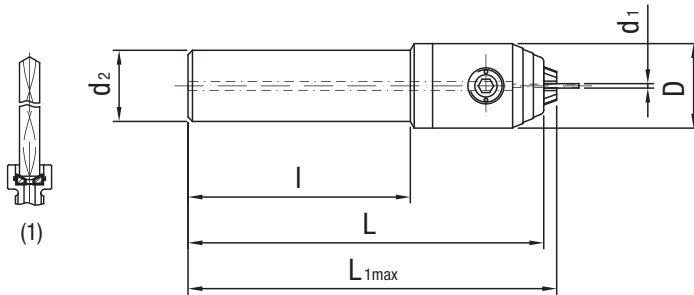

Nominal size Shank	WTE Norm	Clamp. range	Dimensions					Weight [kg]	Order designation	Order No.
			d <sub>1</sub>	D	d <sub>2</sub>	L	L <sub>1 max.</sub>			
16	WTE 06	0.2-6.4	25	16	100	104	60	0.3	40.257.16.06.Z	30564901
16	WTE 06	0.2-6.4	25	16	150	154	110	0.5	40.257.16.06.Z/150	30564903
16	WTE 06	0.2-6.4	25	16	200	204	160	0.7	40.257.16.06.Z/200	30564905
20	WTE 06	0.2-6.4	25	20	100	104	60	0.4	40.257.20.06.Z	30564907
20	WTE 06	0.2-6.4	25	20	150	154	110	0.6	40.257.20.06.Z/150	30565004
20	WTE 06	0.2-6.4	25	20	200	204	160	0.8	40.257.20.06.Z/200	30565008

(1) WTE 06 sealing disk (ø 0.5 mm) included in scope of supply, for inner coolant drills ø 0.7-6.4 mm with smooth shank acc. to DIN 6535 Form HA.

## Hexagonal T-key

For pinion activation

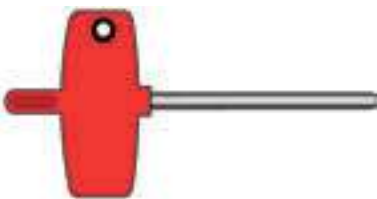

sw	l	Weight [kg]	WTE Norm	Order designation	Order No.
2	60	0.01	WTE 03	89.206.08	30435838
2.5	60	0.01	WTE 06	89.206.10	10098110

Dimensions in mm.  
Custom designs available on request.