

**Characteristics:**

Boring head for internal turning applications equipped with trigon negative inserts (angle 80°). For general applications, roughing, semi-finishing and finishing.

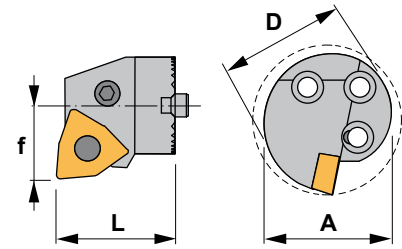

**Eigenschaften:**

Bohrkopf zum Innendrehen mit negativen Trigon Wendeschneidplatten (80° Winkel). Für allgemeine Anwendungen, Schruppen, Vorschlichten und Schlichten.

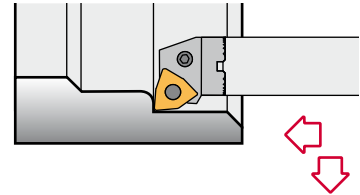

## PWLN 95°-N

| Reference<br>Bezeichnung | D  | L  | f  | A  | Insert size<br>Wendeschneidplatte | kg    |
|--------------------------|----|----|----|----|-----------------------------------|-------|
| A32X PWLN R/L 08-N       | 32 | 30 | 22 | 40 | WNM.. 0804..                      | 0,150 |
| A40X PWLN R/L 08-N       | 40 | 30 | 27 | 50 | WNM.. 0804..                      | 0,300 |
| A50X PWLN R/L 08-N       | 50 | 40 | 35 | 63 | WNM.. 0804..                      | 0,600 |
| A60X PWLN R/L 08-N       | 60 | 40 | 43 | 80 | WNM.. 0804..                      | 0,800 |

| Reference<br>Bezeichnung |      |      |      |      |      |      | Nm  |
|--------------------------|------|------|------|------|------|------|-----|
| A32X PWLN R/L 08-N       | 8312 | 1648 | 5003 | 3008 | 4112 | 0012 | 3.0 |
| A40X PWLN R/L 08-N       | 8012 | 1608 | 5003 | 3008 | 4112 | 0012 | 3.0 |
| A50X PWLN R/L 08-N       | 8012 | 1608 | 5003 | 3008 | 4112 | 0012 | 3.0 |
| A60X PWLN R/L 08-N       | 8012 | 1608 | 5003 | 3008 | 4112 | 0012 | 3.0 |

### WNMG 80° trigon negative inserts. 80° trigon negative Wendeschneidplatten. A50-51

| Reference / Bez. | l    | s    | d     |
|------------------|------|------|-------|
| WNMG 0804..      | 8,14 | 4,76 | 12,70 |

