

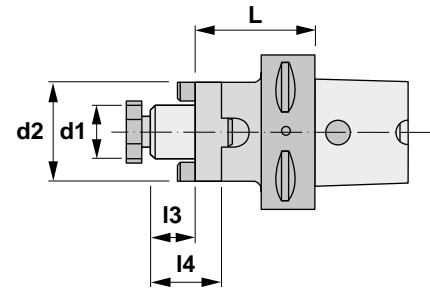





Characteristics:
Combi-Shell mill adaptor.
PSC ISO 26623-1
For cutters with keyway or driving slot
DIN 138.

Eigenschaften:
Kombi-Aufsteckfräsdorne.
PSC ISO 26623-1
Für Fräser mit Längsnut oder
Stirnmitnehmer DIN 138.



18.180

| Reference Bezeichnung | PSC | d1 h6 | L | l3 | l4 | d2 |  |  |  |  |
|--------------------------|-----|-------|-----|----|----|----|---|---|---|---|
| 18.180.040.16 | 40 | 16 | 50 | 17 | 27 | 32 | 10008 | 60116 | 88016 | 0,450 |
| 18.180.040.22 | 40 | 22 | 50 | 19 | 31 | 40 | 10010 | 60122 | 88022 | 0,590 |
| 18.180.050.16 | 50 | 16 | 50 | 17 | 27 | 32 | 10008 | 60116 | 88016 | 0,640 |
| 18.180.050.22 | 50 | 22 | 50 | 19 | 31 | 40 | 10010 | 60122 | 88022 | 0,770 |
| 18.180.050.27 | 50 | 27 | 50 | 21 | 33 | 48 | 10012 | 60127 | 88027 | 0,930 |
| 18.180.050.32 | 50 | 32 | 60 | 24 | 38 | 58 | 10016 | 60132 | 88032 | 1,360 |
| 18.180.063.16 | 63 | 16 | 90 | 17 | 27 | 32 | 10008 | 60116 | 88016 | 1,160 |
| 18.180.063.22 | 63 | 22 | 90 | 19 | 31 | 40 | 10010 | 60122 | 88022 | 1,420 |
| 18.180.063.27 | 63 | 27 | 90 | 21 | 33 | 48 | 10012 | 60127 | 88027 | 1,740 |
| 18.180.063.32 | 63 | 32 | 90 | 24 | 38 | 58 | 10016 | 60132 | 88032 | 2,220 |
| 18.180.063.40 | 63 | 40 | 90 | 27 | 41 | 70 | 10020 | 60140 | 88040 | 2,940 |
| 18.180.080.16 | 80 | 16 | 100 | 17 | 27 | 32 | 10008 | 60116 | 88016 | 2,180 |
| 18.180.080.22 | 80 | 22 | 100 | 19 | 31 | 40 | 10010 | 60122 | 88022 | 2,450 |
| 18.180.080.27 | 80 | 27 | 100 | 21 | 33 | 48 | 10012 | 60127 | 88027 | 2,780 |
| 18.180.080.32 | 80 | 32 | 100 | 24 | 38 | 58 | 10016 | 60132 | 88032 | 3,280 |
| 18.180.080.40 | 80 | 40 | 100 | 27 | 41 | 70 | 10020 | 60140 | 88040 | 4,070 |
| 18.180.080.50 | 80 | 50 | 100 | 30 | 46 | 90 | 10024 | 60150 | 88050 | 5,550 |
| 18.180.100.16 | 100 | 16 | 100 | 17 | 27 | 32 | 10008 | 60116 | 88016 | 3,540 |
| 18.180.100.22 | 100 | 22 | 100 | 19 | 31 | 40 | 10010 | 60122 | 88022 | 3,800 |
| 18.180.100.27 | 100 | 27 | 100 | 21 | 33 | 48 | 10012 | 60127 | 88027 | 4,130 |
| 18.180.100.32 | 100 | 32 | 100 | 24 | 38 | 58 | 10016 | 60132 | 88032 | 4,610 |
| 18.180.100.40 | 100 | 40 | 100 | 27 | 41 | 70 | 10020 | 60140 | 88040 | 5,330 |
| 18.180.100.50 | 100 | 50 | 100 | 30 | 46 | 90 | 10024 | 60150 | 88050 | 6,820 |

