



**HYDRAULIC CHUCK (Radial tool length pre-setting type)**

-  **HYDRAULIK SPANNFUTTER (Radiale Werkzeuglängen Voreinstellung)**
-  **Mandrin Hydraulique (Banc de pr -Élage radial)**
-  **MMandrini Idraulici (Utensili radiali per azzeramento)**

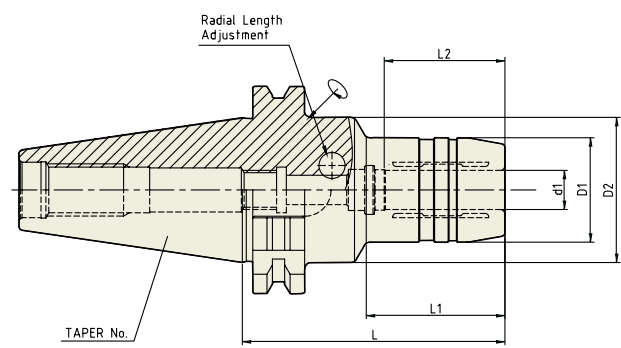

<b>DIN 69871 -SK</b>	<b>Taper Accuracy AT3</b>	<b>G Value 2.5</b>	<b>RPM 25,000</b>	<b>Run-Out (at 3D) ≤3Um</b>	<b>Coolant System AD/B</b>
----------------------	---------------------------	--------------------	-------------------	-----------------------------	----------------------------

**■ DIN 69871-SK**

Unit : mm

TAPER No.	MODEL No.	d1	D1	D2	L	L1	L2	Weight (Kg)	Stock
30	SK30AD/B-HCR12-85	12	32	44.5	85	40	37	0.90	●
	SK30AD/B-HCR20-85	20	44.5	-	85	-	42	1.00	
40	SK40AD/B-HCR12-80.5	12	32	49.5	80.5	31.5	37	1.50	●
	SK40AD/B-HCR20-80.5	20	42	49.5	80.5	34	42	1.60	●
	SK40AD/B-HCR32-110	32	63	80	110	50	55	2.20	
50	SK50AD/B-HCR12-80.5	12	32	49.5	80.5	31.5	37	3.90	
	SK50AD/B-HCR20-80.5	20	42	49.5	80.5	34	42	4.00	
	SK50AD/B-HCR32-100	32	60	-	100	-	55	4.70	●

- ▶ CAT(ANSI B5.50) taper and Inch type products are available.
- ▶ For applicable Hydraulic Chuck collet, please refer to page 31~34.

# HYDRAULIC CHUCK

# HC

## HYDRAULIC CHUCK (SHORT & RIGID)

 HYDRAULIK SPANNFUTTER (KURZ UND STARR)

 Mandrin Hydraulique (COURT et RIGIDE)

 Mandrini idraulici (CORTO e RIGIDO)

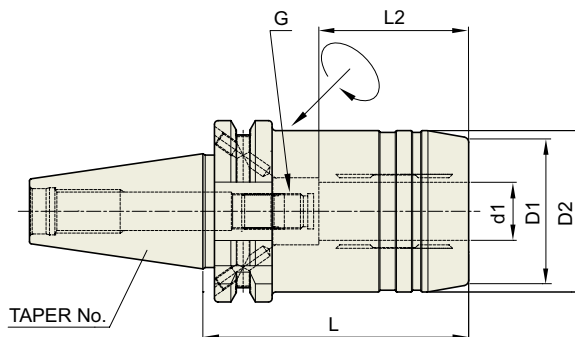

DIN 69871 -SK	Taper Accuracy AT3	G Value 2.5	RPM 25,000	Run-Out (at 3D) ≤3Um	Coolant System AD/B
---------------	-----------------------	----------------	---------------	-------------------------	------------------------

### ■ DIN 69871-SK



Unit : mm

TAPER No.	MODEL No.	d1	D1	D2	L	L2	G	Weight (Kg)	Stock
30	SK30AD/B-HC20S-85	20	41	44	85	42	M10×1.0	0.53	●
40	SK40AD/B-HC12S-50	12	32	42	50	37	M8×1.0	1.1	●
	SK40AD/B-HC20S-64.5	20	37	49.25	64.5	42	M16×1.0	1.26	●
50	SK50AD/B-HC12S-50	12	32	42	50	37	M8×1.0	2.8	
	SK50AD/B-HC20S-64.5	20	37	49.5	64.5	42	M16×1.0	3.1	
	SK50AD/B-HC32S-81	32	55	72	81	55	M16×1.0	4.1	●

▶ CAT(ANSI B5.50) taper and Inch type products are available.

▶ For applicable Hydraulic Chuck collet, please refer to page 31~34.

**HYDRAULIC CHUCK (SLIM)**

-  **HYDRAULIK SPANNFUTTER (SCHLANK)**
-  **Mandrin Hydraulique (mince)**
-  **Mandrini Idraulici (sottile)**

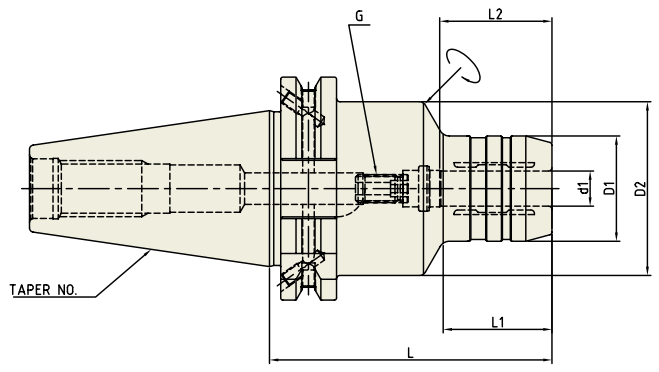

<b>DIN 69871 -SK</b>	<b>Taper Accuracy</b> AT3	<b>G Value</b> 2.5	<b>RPM</b> 25,000	<b>Run-Out (at 3D)</b> ≤3Uμm	<b>Coolant System</b> AD/B
----------------------	------------------------------	-----------------------	----------------------	---------------------------------	-------------------------------

**■ DIN 69871-SK**

Unit : mm

TAPER No.	MODEL No.	d1	D1	D2	L	L1	L2	G	Weight (Kg)	Stock
30	SK30AD/B-HC6-70	6	26	45	70	20	27	M5x0.8	0.65	●
	SK30AD/B-HC8-70	8	28	45	70	20	27	M6x1.0	0.65	
	SK30AD/B-HC10-75	10	30	45	75	21	32	M8x1.0	0.73	●
	SK30AD/B-HC12-85	12	32	45	85	22	37	M10x1.0	0.80	
	SK30AD/B-HC14-85	14	34	45	85	22	37	M10x1.0	0.80	
	SK30AD/B-HC16-90	16	38	45	90	50	42	M6x1.0	0.90	
	SK30AD/B-HC18-90	18	40	45	90	50	42	M6x1.0	0.90	
	SK30AD/B-HC20-90	20	42	45	90	50	42	M6x1.0	0.90	
40	SK40AD/B-HC6-80.5	6	26	49.5	80.5	29.5	27	M5x0.8	1.31	●
	SK40AD/B-HC6-110	6	26	49.5	110	29.5	27	M5x0.8	1.76	
	SK40AD/B-HC8-80.5	8	28	49.5	80.5	30	27	M6x1.0	1.34	●
	SK40AD/B-HC8-110	8	28	49.5	110	30	27	M6x1.0	1.76	
	SK40AD/B-HC10-80.5	10	30	49.5	80.5	31	32	M8x1.0	1.34	●
	SK40AD/B-HC10-110	10	30	49.5	110	31	32	M8x1.0	1.76	
	SK40AD/B-HC12-80.5	12	32	49.5	80.5	31.5	37	M10x1.0	1.34	●
	SK40AD/B-HC12-110	12	32	49.5	110	31.5	37	M10x1.0	1.76	
	SK40AD/B-HC16-80.5	16	38	49.5	80.5	33	42	M12x1.0	1.34	●
	SK40AD/B-HC16-110	16	38	49.5	110	33	42	M12x1.0	1.76	
	SK40AD/B-HC20-80.5	20	42	49.5	80.5	34	42	M16x1.0	1.35	●
	SK40AD/B-HC20-110	20	42	49.5	110	34	42	M16x1.0	1.78	
	SK40AD/B-HC25-80.5	25	55	66	80.5	22	48	M16x1.0	1.75	
	SK40AD/B-HC32-80.5	32	63	80	80.5	25.5	55	M16x1.0	2.60	
50	SK50AD/B-HC6-80.5	6	26	49.5	80.5	30	27	M5x0.8	3.00	
	SK50AD/B-HC8-80.5	8	28	49.5	80.5	30	27	M6x1.0	3.00	
	SK50AD/B-HC10-80.5	10	30	49.5	80.5	32	32	M8x1.0	3.00	
	SK50AD/B-HC12-80.5	12	32	49.5	80.5	35	37	M10x1.0	3.05	
	SK50AD/B-HC16-80.5	16	38	49.5	80.5	40	42	M12x1.0	3.10	
	SK50AD/B-HC20-80.5	20	42	49.5	80.5	40	42	M16x1.0	3.15	

- ▶ CAT(ANSI B5.50) taper and Inch type products are available.
- ▶ For applicable Hydraulic Chuck collet, please refer to page 31~34.

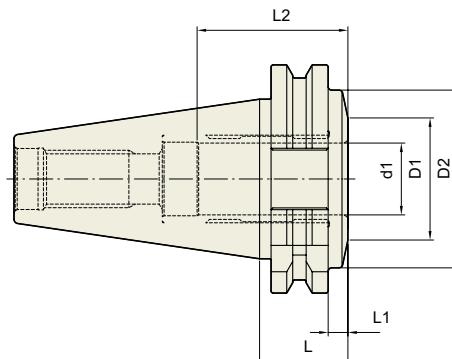
**HYDRAULIC  
CHUCK****HC****HYDRAULIC CHUCK (ULTRA SHORT)**
 **HYDRAULIK SPANNFUTTER (KURZ)**
 **Mandrin Hydraulique (court)**
 **Mandrini idraulici (corto)**
DIN 69871  
-SKTaper  
Accuracy  
AT3G Value  
2.5RPM  
25,000Run-Out  
(at 3D)  
≤3UmCoolant  
System  
AD■ **DIN 69871-SK**

Unit : mm

TAPER No.	MODEL No.	d1	D1	D2	L	L1	L2	G	Weight (Kg)	Stock
40	<b>SK40-HC20-24.6</b>	20	34	49.5	24.6	5.5	42	-		
50	<b>SK50-HC32-30.9</b>	32	44.5	70.5	30.9	11.85	55	-		

▶ CAT(ANSI B5.50) taper and Inch type products area available.

▶ For applicable Hydraulic Chuck collet, please refer to page 31~34.

# HYDRAULIC CHUCK

# HCR

**HYDRAULIC CHUCK (Radial tool length pre-setting type)**  
 ■ HYDRAULIK SPANNFUTTER (RADIALE WERKZEUGLÄGEN VOREINSTELLUNG)  
 ■ Mandrin Hydraulique (Banc de pr -rÉlage radial)  
 ■ Mandrini Idraulici (Utensili radiali per azzeramento)

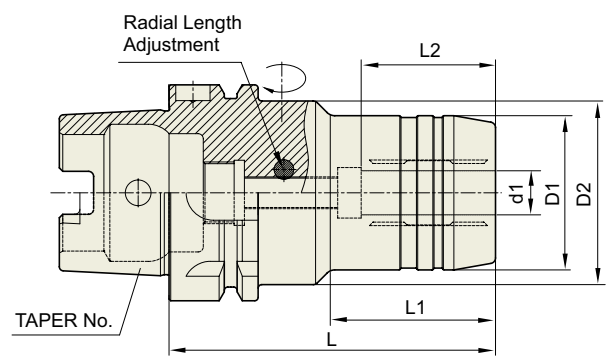

DIN 69893 -HSK	Taper Accuracy -	G Value 2.5	RPM 25,000	Run-Out (at 3D) ≤3Uμm	Coolant System AD
----------------	---------------------	----------------	---------------	--------------------------	----------------------

■ DIN 69893/ISO 12164-1-HSK FORM A

Unit : mm

TAPER No.	MODEL No.	d1	D1	D2	L	L1	L2	Weight (Kg)	Stock
40A	HSK40A-HCR6-80	6	26	34	80	36	27	0.55	
	HSK40A-HCR8-80	8	28	34	80	36	27	0.55	
	HSK40A-HCR10-85	10	30	34	85	43	32	0.65	
	HSK40A-HCR12-90	12	32	34	90	48	37	0.70	
50A	HSK50A-HCR6-80	6	26	40	80	35	27	0.70	
	HSK50A-HCR8-80	8	28	40	80	35	27	0.70	
	HSK50A-HCR10-85	10	30	40	85	38	32	0.73	
	HSK50A-HCR12-90	12	32	40	90	40	37	0.80	
	HSK50A-HCR14-90	14	34	40	90	40	37	0.80	
	HSK50A-HCR16-95	16	38	53	95	34	42	1.00	
	HSK50A-HCR18-95	18	40	57	95	34	42	1.00	
HSK50A-HCR20-100	20	42	60	100	39	42	1.10		
63A	HSK63A-HCR6-80	6	26	50	80	33	27	0.96	
	HSK63A-HCR8-80	8	28	50	80	33	27	0.98	
	HSK63A-HCR10-85	10	30	50	85	38	32	1.04	
	HSK63A-HCR12-90	12	32	50	90	40	37	1.06	
	HSK63A-HCR14-90	14	34	50	90	46	37	1.08	
	HSK63A-HCR16-95	16	38	50	95	51	42	1.18	
	HSK63A-HCR18-95	18	40	50	95	52	42	1.20	
	HSK63A-HCR20-100	20	42	50	100	51	42	1.22	●
HSK63A-HCR25-120	25	57	63	120	54.5	48	2.20		
HSK63A-HCR32-125	32	64	75	125	57.5	55	2.60	●	
100A	HSK100A-HCR6-85	6	26	63	85	33	27	3.60	
	HSK100A-HCR8-85	8	28	63	85	33	27	3.60	
	HSK100A-HCR10-90	10	30	63	90	36	32	3.80	
	HSK100A-HCR12-95	12	32	63	95	40	37	3.80	
	HSK100A-HCR14-95	14	34	63	95	41	37	3.80	
	HSK100A-HCR16-100	16	38	63	100	46	42	3.90	
	HSK100A-HCR18-100	18	40	63	100	46	42	3.90	
	HSK100A-HCR20-105	20	42	75	105	51	42	4.20	
	HSK100A-HCR25-115	25	57	75	115	55.5	48	4.40	
	HSK100A-HCR32-120	32	64	75	120	63.5	55	4.60	

► For applicable Hydraulic Chuck collet, please refer to page 31~34.

# HYDRAULIC CHUCK

# HC

## HYDRAULIC CHUCK (SHORT & RIGID)

 HYDRAULIK SPANNFUTTER (KURZ UND STARR)

 Mandrin Hydraulique (COURT et RIGIDE)

 Mandrini idraulici (CORTO e RIGIDO)

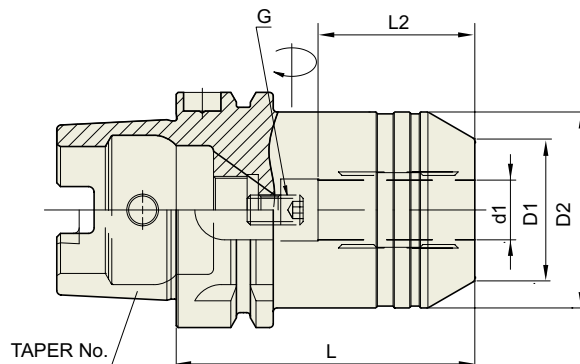

DIN 69893 - HSK	Taper Accuracy -	G Value 2.5	RPM 25,000	Run-Out (at 3D) ≤3Um	Coolant System AD
-----------------	---------------------	----------------	---------------	-------------------------	----------------------

### ■ DIN 69893/ISO12164-1-HSK FORM A

Unit : mm

TAPER No.	MODEL No.	d1	D1	D2	L	L2	G	Weight (Kg)	Stock
63A	HSK63A-HC12S-80	12	32	42	80	37	M8×1.0		●
	HSK63A-HC20S-80	20	38	52.5	80	42	M8×1.0		●

► For applicable Hydraulic Chuck collet, please refer to page 31~34.

**HYDRAULIC CHUCK (SLIM)**  
 ■ HYDRAULIK SPANNFUTTER (SCHLANK)  
 ■ Mandrin Hydraulique (mince)  
 ■ Mandrini Idraulici (sottile)

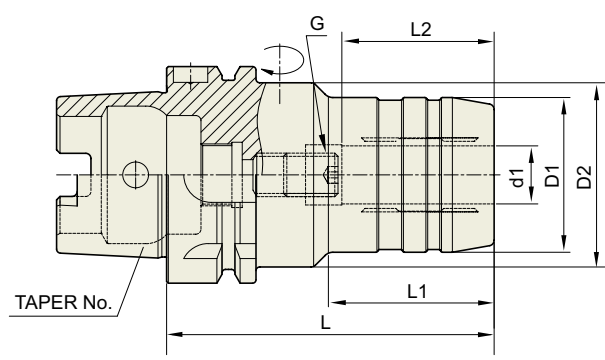

DIN 69893 -HSK	Taper Accuracy -	G Value 2.5	RPM 25,000	Run-Out (at 3D) ≤3Um	Coolant System AD
----------------	---------------------	----------------	---------------	-------------------------	----------------------

■ **DIN 69893/ISO 12164-1-HSK FORM A**

Unit : mm

TAPER No.	MODEL No.	d1	D1	D2	L	L1	L2	G	Weight (Kg)	Stock
32A	HSK32A-HC6-80	6	26	40	80	29	27	M5x0.8	0.30	
	HSK32A-HC8-80	8	28	40	80	29	27	M6x1.0	0.30	
	HSK32A-HC10-85	10	30	40	85	35	32	M6x1.0	0.30	
	HSK32A-HC12-90	12	32	40	90	40	37	M6x1.0	0.30	
40A	HSK40A-HC6-70	6	26	34	70	36	27	M5x0.8	0.50	●
	HSK40A-HC8-70	8	28	34	70	36	27	M6x1.0	0.50	●
	HSK40A-HC10-75	10	30	34	75	42	32	M6x1.0	0.60	●
	HSK40A-HC12-80	12	32	34	80	48	37	M6x1.0	0.65	
50A	HSK50A-HC6-70	6	26	40	70	28	27	M5x0.8	0.65	●
	HSK50A-HC8-70	8	28	40	70	28	27	M6x1.0	0.65	●
	HSK50A-HC10-75	10	30	40	75	34	32	M8x1.0	0.70	●
	HSK50A-HC12-85	12	32	40	85	44	37	M10x1.0	0.75	●
	HSK50A-HC14-85	14	34	40	85	44	37	M10x1.0	0.75	●
	HSK50A-HC16-90	16	38	53	90	30	42	M12x1.0	0.90	●
63A	HSK50A-HC18-90	18	40	57	90	30	42	M12x1.0	0.90	
	HSK50A-HC20-90	20	42	60	90	29	42	M16x1.0	1.00	
	HSK63A-HC6-70	6	26	50	70	24	27	M5x0.8	0.53	●
	HSK63A-HC8-70	8	28	50	70	25	27	M6x1.0	0.55	●
	HSK63A-HC10-80	10	30	50	80	35	32	M8x1.0	1.00	●
	HSK63A-HC12-85	12	32	50	85	40	37	M10x1.0	1.03	●
	HSK63A-HC14-85	14	34	50	85	40	37	M10x1.0	1.05	
	HSK63A-HC16-90	16	38	50	90	46	42	M12x1.0	1.15	●
80A	HSK63A-HC18-90	18	40	50	90	47	42	M12x1.0	1.15	
	HSK63A-HC20-90	20	42	50	90	48	42	M16x1.0	1.20	●
	HSK63A-HC25-120	25	57	63	120	59	48	M16x1.0	2.20	●
	HSK63A-HC32-125	32	64	75	125	63	55	M16x1.0	2.40	●
100A	HSK80A-HC12-85	12	32	50	85	40	37	M10x1.0		
	HSK80A-HC20-95	20	42	50	95	52	42	M16x1.0		
	HSK80A-HC32-125	32	64	75	125	63	55	M16x1.0		
100A	HSK100A-HC6-75	6	26	50	75	26	27	M5x0.8	3.20	
	HSK100A-HC8-75	8	28	50	75	26	27	M6x1.0	3.20	
	HSK100A-HC10-90	10	30	50	90	42	32	M8x1.0	3.40	
	HSK100A-HC12-95	12	32	50	95	47	37	M10x1.0	3.40	
	HSK100A-HC14-95	14	34	50	95	47	37	M10x1.0	3.40	
	HSK100A-HC16-100	16	38	50	100	53	42	M12x1.0	3.50	
	HSK100A-HC18-100	18	40	50	100	53	42	M12x1.0	3.60	
	HSK100A-HC20-105	20	42	50	105	59	42	M16x1.0	4.00	
HSK100A-HC25-110	25	57	63	110	62	48	M16x1.0	4.20		
HSK100A-HC32-110	32	64	75	110	62	55	M16x1.0	4.30		

► For applicable Hydraulic Chuck collet, please refer to page 31~34.



# HYDRAULIC CHUCK

# HC

## HYDRAULIC CHUCK (SLIM)

 HYDRAULIK SPANNFUTTER (SCHLANK)

 Mandrin Hydraulique (mince)

 Mandrini Idraulici (sottile)

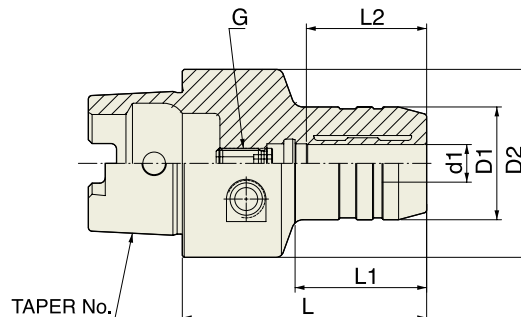

DIN 69893  
- HSK

Taper Accuracy  
-

G Value  
2.5

RPM  
25,000

Run-Out (at 3D)  
≤3Um

Coolant System  
AD

### ■ DIN 69893/ISO 12164-1-HSK FORM C

Unit : mm

TAPER No.	MODEL No.	d1	D1	D2	L	L1	L2	G	Weight (Kg)	Stock
32C	HSK32C-HC6-65	6	26	32	65	33	27	M5x0.8		
	HSK32C-HC8-70	8	28	32	70	34	27	M6x1.0		
	HSK32C-HC10-75	10	30	32	75	39	32	M6x1.0		
	HSK32C-HC12-80	12	32	32	80	45	37	M6x1.0		
40C	HSK40C-HC6-60	6	26	40	60	35	27	M5x0.8		
	HSK40C-HC8-60	8	28	40	60	36	27	M6x1.0		
	HSK40C-HC10-65	10	30	40	65	41	32	M6x1.0		
	HSK40C-HC12-70	12	32	40	70	47	37	M6x1.0		
50C	HSK50C-HC6-60	6	26	50	60	30	27	M5x0.8		
	HSK50C-HC8-60	8	28	50	60	30	27	M6x1.0		
	HSK50C-HC10-65	10	30	50	65	35	32	M8x1.0		
	HSK50C-HC12-75	12	32	50	75	44	37	M10x1.0		
	HSK50C-HC14-75	14	34	50	75	46	37	M10x1.0		
	HSK50C-HC16-80	16	38	50	80	51	42	M12x1.0		
	HSK50C-HC18-80	18	40	50	80	51	42	M12x1.0		
63C	HSK63C-HC6-60	6	26	63	60	25	27	M5x0.8		
	HSK63C-HC8-60	8	28	63	60	25	27	M6x1.0		
	HSK63C-HC10-65	10	30	63	65	31	32	M8x1.0		
	HSK63C-HC12-75	12	32	63	75	41	37	M10x1.0		
	HSK63C-HC14-75	14	34	63	75	42	37	M10x1.0		
	HSK63C-HC16-80	16	38	63	80	48	42	M12x1.0		
	HSK63C-HC18-80	18	40	63	80	48	42	M12x1.0		
	HSK63C-HC20-80	20	42	63	80	49	42	M16x1.0		
	HSK63C-HC25-95	25	57	63	95	63	48	M16x1.0		
HSK63C-HC32-100	32	63	63	100	-	55	M16x1.0			

► For applicable Hydraulic Chuck collet, please refer to page 31~34.



**YG HYDRAULIC CHUCK**

**HC**

**HYDRAULIC CHUCK (SLIM)**  
 HYDRAULIK SPANNFUTTER (SCHLANK)  
 Mandrin Hydraulique (mince)  
 Mandrini Idraulici (sottile)

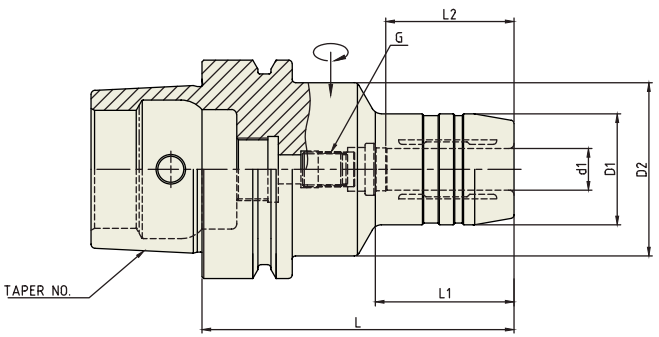

DIN 69893 -HSK	Taper Accuracy -	G Value 2.5	RPM 25,000	Run-Out (at 3D) ≤3Uμm	Coolant System AD
----------------	---------------------	----------------	---------------	--------------------------	----------------------

■ DIN 69893/ISO 12164-1-HSK FORM E & F

Unit : mm

TAPER No.	MODEL No.	d1	D1	D2	L	L1	L2	G	Weight (Kg)	Stock
40E	HSK40E-HC6-70	6	26	33.5	70	36	27	M5x0.8		
	HSK40E-HC8-70	8	28	33.5	70	36	27	M6x1.0		
	HSK40E-HC10-75	10	30	33.5	75	42	32	M6x1.0		
	HSK40E-HC12-80	12	32	33.5	80	48	37	M6x1.0		
50E	HSK50E-HC6-70	6	26	40	70	28	27	M5x1.0		
	HSK50E-HC8-70	8	28	40	70	28	27	M6x1.0		
	HSK50E-HC10-75	10	30	40	75	34	32	M8x1.0		
	HSK50E-HC12-85	12	32	40	85	44	37	M10x1.0		
	HSK50E-HC16-90	16	38	53	90	30	42	M12x1.0		
	HSK50E-HC20-90	20	42	60	90	29	42	M16x1.0		
63F	HSK63F-HC20-85	20	42	50	85	46	42	M12x1.0		

► For applicable Hydraulic Chuck collet, please refer to page 31~34.



# HYDRAULIC CHUCK

# HCR

## HYDRAULIC CHUCK (RADIAL TOOL LENGTH PRE-SETTING TYPE)

HYDRAULIK SPANNFUTTER (SCHLANK)

Mandrin Hydraulique (mince)

Mandrini Idrraulici (sottile)

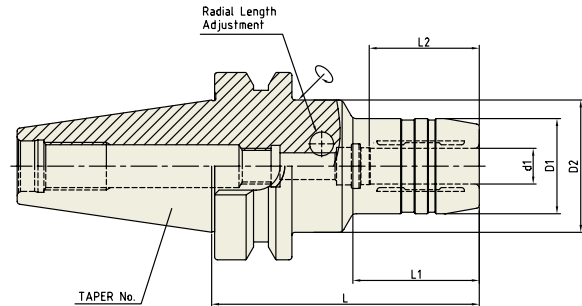

CBT	Taper Accuracy AT3	G Value 2.5	RPM 25,000	Run-Out (at 3D) ≤3Um	Coolant System AD
-----	-----------------------	----------------	---------------	-------------------------	----------------------

### ■ CBT (BT DUAL CONTACT)

Unit : mm

TAPER No.	MODEL No.	d1	D1	D2	L	L1	L2	Weight (Kg)	Stock
30	CBT30-HCR12-85	12	32	44.5	85	40	37	0.90	
	CBT30-HCR20-85	20	44	44	85	-	42	1.00	●
40	CBT40-HCR12-90	12	32	44.5	90	44.5	37	1.50	
	CBT40-HCR20-90	20	42	49.5	90	47.5	42	1.60	●
	CBT40-HCR32-105	32	60	60	105	-	55	2.20	
50	CBT50-HCR12-95	12	32	44.5	95	34	37	3.90	
	CBT50-HCR20-100	20	42	44.5	100	44	42	4.00	
	CBT50-HCR32-115	32	60	60	115	-	55	4.10	●

▶ For applicable Hydraulic Chuck collet, please refer to page 31~34.

# HYDRAULIC CHUCK

# HC

**HYDRAULIC CHUCK (SLIM)**  
 ■ HYDRAULIK SPANNFUTTER (SCHLANK)  
 ■ Mandrin Hydraulique (mince)  
 ■ Mandrini Idraulici (sottile)

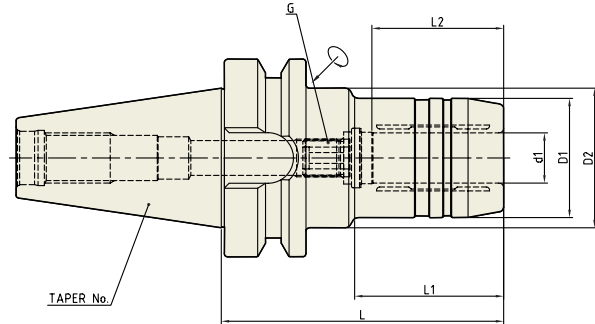

CBT	Taper Accuracy <b>AT3</b>	G Value <b>2.5</b>	RPM <b>25,000</b>	Run-Out (at 3D) <b>≤3Um</b>	Coolant System <b>AD</b>
-----	------------------------------	-----------------------	----------------------	--------------------------------	-----------------------------

■ **CBT (BT DUAL CONTACT)**

Unit : mm

TAPER No.	MODEL No.	d1	D1	D2	L	L1	L2	G	Weight (Kg)	Stock
30	CBT30-HC6-70	6	26	44.5	70	29.5	27	M5x0.8	0.65	
	CBT30-HC8-70	8	28	44.5	70	30	27	M6x1.0	0.65	
	CBT30-HC10-75	10	30	44.5	75	31	32	M8x1.0	0.73	
	CBT30-HC12-85	12	32	45	85	45	37	M10x1.0	0.80	●
	CBT30-HC14-85	14	34	45	85	45	37	M10x1.0	0.80	
	CBT30-HC16-90	16	38	45	90	50	42	M10x1.0	0.90	
	CBT30-HC18-90	18	40	45	90	50	42	M10x1.0	0.90	
	CBT30-HC20-90	20	42	45	90	50	42	M6x1.0	0.90	●
40	CBT40-HC6-90	6	26	44.5	90	43	27	M5x0.8	1.30	
	CBT40-HC8-90	8	28	44.5	90	44.5	27	M6x1.0	1.30	
	CBT40-HC10-90	10	30	44.5	90	44.5	32	M8x1.0	1.35	
	CBT40-HC12-90	12	32	44.5	90	44.5	37	M10x1.0	1.35	●
	CBT40-HC14-90	14	34	44.5	90	44.5	37	M10x1.0	1.35	
	CBT40-HC16-90	16	38	44.5	90	47.5	42	M12x1.0	1.40	
	CBT40-HC18-90	18	40	44.5	90	47.5	42	M12x1.0	1.45	
	CBT40-HC20-90	20	42	44.5	90	47.5	42	M16x1.0	1.50	●
	CBT40-HC25-100	25	50	60	100	47.5	48	M16x1.0	1.70	
	CBT40-HC32-105	32	60	60	105	-	55	M16x1.0	2.10	●

► For applicable Hydraulic Chuck collet, please refer to page 31~34.



## HYDRAULIC CHUCK (SLIM)

HYDRAULIK SPANNFUTTER (SCHLANK)

Mandrin Hydraulique (mince)

Mandrini Idraulici (sottile)

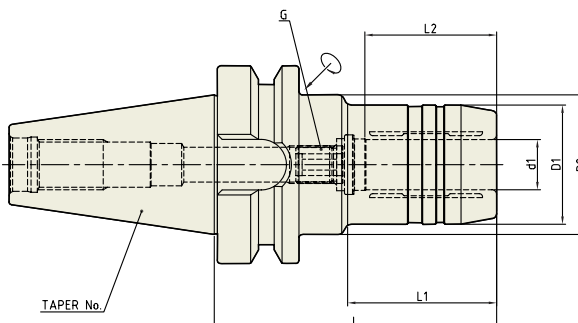

CBT	Taper Accuracy AT3	G Value 2.5	RPM 25,000	Run-Out (at 3D) ≤3Um	Coolant System AD
-----	-----------------------	----------------	---------------	-------------------------	----------------------

### ■ CBT (BT DUAL CONTACT)

Unit : mm

TAPER No.	MODEL No.	d1	D1	D2	L	L1	L2	G	Weight (Kg)	Stock
50	CBT50-HC6-90	6	26	44.5	90	34	27	M5×0.8	3.75	
	CBT50-HC6-120	6	26	44.5	120	34	27	M5×0.8	4.10	
	CBT50-HC6-150	6	26	44.5	150	34	27	M5×0.8	4.70	
	CBT50-HC8-90	8	28	44.5	90	34	27	M6×1.0	3.75	
	CBT50-HC8-120	8	28	44.5	120	34	27	M6×1.0	4.10	
	CBT50-HC8-150	8	28	44.5	150	34	27	M6×1.0	4.10	
	CBT50-HC10-90	10	30	44.5	90	34	32	M8×1.0	3.90	
	CBT50-HC10-120	10	30	44.5	120	34	32	M8×1.0	4.30	
	CBT50-HC10-150	10	30	44.5	150	34	32	M8×1.0	4.90	
	CBT50-HC12-90	12	32	44.5	90	34	37	M10×1.0	3.90	●
	CBT50-HC12-120	12	32	44.5	120	34	37	M10×1.0	4.30	
	CBT50-HC12-150	12	32	44.5	150	34	37	M10×1.0	4.90	
	CBT50-HC14-90	14	34	44.5	90	34	37	M10×1.0	3.90	
	CBT50-HC14-120	14	34	44.5	120	34	37	M10×1.0	4.30	
	CBT50-HC14-150	14	34	44.5	150	34	37	M10×1.0	4.90	
	CBT50-HC16-90	16	38	44.5	90	34	42	M12×1.0	4.00	
	CBT50-HC16-120	16	38	44.5	120	34	42	M12×1.0	4.40	
	CBT50-HC16-150	16	38	44.5	150	34	42	M12×1.0	5.00	
	CBT50-HC18-90	18	40	44.5	90	34	42	M12×1.0	4.00	
	CBT50-HC18-120	18	40	44.5	120	34	42	M12×1.0	4.40	
	CBT50-HC18-150	18	40	44.5	150	34	42	M12×1.0	5.00	
	CBT50-HC20-90	20	42	44.5	90	34	42	M16×1.0	4.00	●
	CBT50-HC20-120	20	42	44.5	120	34	42	M16×1.0	4.40	
	CBT50-HC20-150	20	42	44.5	150	34	42	M16×1.0	5.00	
CBT50-HC25-105	25	57	63	105	52	48	M16×1.0	4.40		
CBT50-HC25-150	25	57	63	150	97	48	M16×1.0	5.60		
CBT50-HC32-115	32	64	75	115	62	55	M16×1.0	4.70	●	
CBT50-HC32-150	32	64	75	150	97	55	M16×1.0	6.00		

► For applicable Hydraulic Chuck collet, please refer to page 31~34.

# YG HYDRAULIC CHUCK

# HCR

## HYDRAULIC CHUCK (RADIAL TOOL LENGTH PRE-SETTING TYPE)

- HYDRAULIK SPANNFUTTER (RADIALE WERKZEUGLÄGEN VOREINSTELLUNG)
- Mandrin Hydraulique (Banc de pr -rÉlage radial)
- Mandrini Idraulici (Utensili radiali per azzeramento)

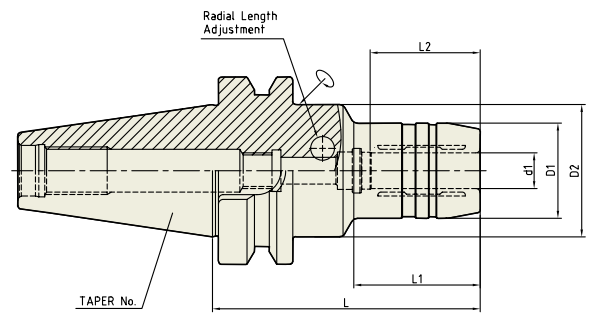

JIS B6339 -BT	Taper Accuracy <b>AT3</b>	G Value <b>2.5</b>	RPM <b>25,000</b>	Run-Out (at 3D) <b>≤3Um</b>	Coolant System <b>AD/B</b>
------------------	---------------------------------	-----------------------	----------------------	-----------------------------------	----------------------------------

### ■ JIS B6339/MAS 403-BT

Unit : mm

TAPER No.	MODEL No.	d1	D1	D2	L	L1	L2	Weight (Kg)	Stock
30	BT30AD/B-HCR12-85	12	32	44.5	85	40	37	0.90	●
	BT30AD/B-HCR20-85	20	44	44	85	-	42	1.00	●
40	BT40AD/B-HCR12-90	12	32	44.5	90	44.5	37	1.50	●
	BT40AD/B-HCR20-90	20	42	49.5	90	47.5	42	1.60	●
	BT40AD/B-HCR32-105	32	60	60	105	-	55	2.20	●
50	BT50AD/B-HCR12-95	12	32	44.5	95	34	37	3.90	●
	BT50AD/B-HCR20-100	20	42	44.5	100	44	42	4.00	●
	BT50AD/B-HCR32-115	32	60	60	115	-	55	4.10	●

- ▶ CAT(ANSI B5.50) taper and Inch type products are available.
- ▶ For applicable Hydraulic Chuck collet, please refer to page 31~34.



# HYDRAULIC CHUCK

# HC

## HYDRAULIC CHUCK (SHORT & RIGID)

HYDRAULIK SPANNFUTTER (KURZ UND STARR)

Mandrin Hydraulique (COURT et RIGIDE)

Mandriini idraulici (CORTO e RIGIDO)

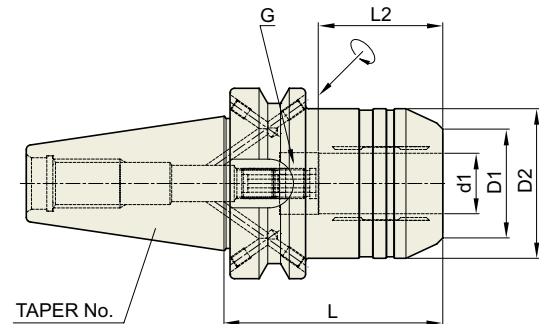

JIS B6339 -BT	Taper Accuracy AT3	G Value 2.5	RPM 25,000	Run-Out (at 3D) ≤3Um	Coolant System AD/B
------------------	--------------------------	----------------	---------------	----------------------------	---------------------------

### ■ JIS B6339/MAS 403-BT

Unit : mm

TAPER No.	MODEL No.	d1	D1	D2	L	L2	G	Weight (Kg)	Stock
30	BT30AD/B-HC20S-85	20	41	44	85	42	M6x1.0	0.93	●
40	BT40AD/B-HC12S-58	12	32	42	58	37	M8x1.0		●
	BT40AD/B-HC20S-72.5	20	38	49.25	72.5	42	M8x1.0	1.40	●
50	BT50AD/B-HC12S-69	12	32	42	69	37	M8x1.0		●
	BT50AD/B-HC20S-90	20	37	49.25	90	42	M8x1.0	3.85	●
	BT50AD/B-HC32S-90	32	55	72	90	55	M8x1.0	4.53	●

▶ CAT(ANSI B5.50) taper and Inch type products are available.

▶ For applicable Hydraulic Chuck collet, please refer to page 31~34.

**HYDRAULIC CHUCK (SLIM)**

HYDRAULIK SPANNFUTTER (SCHLANK)

Mandrin Hydraulique (mince)

Mandrini Idraulici (sottile)

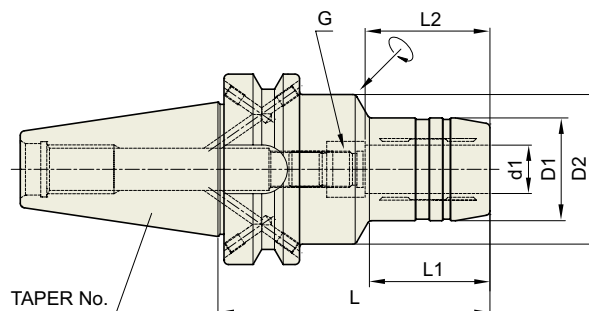

JIS B6339 -BT	Taper Accuracy AT3	G Value 2.5	RPM 25,000	Run-Out (at 3D) ≤3Uμm	Coolant System AD/B
------------------	-----------------------	----------------	---------------	--------------------------	------------------------

**■ JIS B6339/MAS 403-BT**

Unit : mm

TAPER No.	MODEL No.	d1	D1	D2	L	L1	L2	G	Weight (Kg)	Stock
30	BT30AD/B-HC6-70	6	26	44.5	70	29.5	27	M5x0.8	0.65	●
	BT30AD/B-HC8-70	8	28	44.5	70	30	27	M6x1.0	0.65	●
	BT30AD/B-HC10-75	10	30	44.5	75	31	32	M8x1.0	0.73	●
	BT30AD/B-HC12-85	12	32	45	85	45	37	M10x1.0	0.80	●
	BT30AD/B-HC14-85	14	34	45	85	45	37	M10x1.0	0.80	
	BT30AD/B-HC16-90	16	38	45	90	50	42	M10x1.0	0.90	●
	BT30AD/B-HC18-90	18	40	45	90	50	42	M10x1.0	0.90	
	BT30AD/B-HC20-90	20	42	45	90	50	42	M6x1.0	0.90	●
40	BT40AD/B-HC6-90	6	26	44.5	90	43	27	M5x0.8	1.30	●
	BT40AD/B-HC8-90	8	28	44.5	90	44.5	27	M6x1.0	1.30	●
	BT40AD/B-HC10-90	10	30	44.5	90	44.5	32	M8x1.0	1.35	●
	BT40AD/B-HC12-90	12	32	44.5	90	44.5	37	M10x1.0	1.35	●
	BT40AD/B-HC14-90	14	34	44.5	90	44.5	37	M10x1.0	1.35	
	BT40AD/B-HC16-90	16	38	44.5	90	47.5	42	M12x1.0	1.40	●
	BT40AD/B-HC18-90	18	40	44.5	90	47.5	42	M12x1.0	1.45	
	BT40AD/B-HC20-90	20	42	44.5	90	47.5	42	M16x1.0	1.50	●
	BT40AD/B-HC25-100	25	50	60	100	47.5	48	M16x1.0	1.70	●
BT40AD/B-HC32-105	32	60	-	105	-	55	M16x1.0	2.10	●	

▶ CAT(ANSI B5.50) taper and Inch type products are available.

▶ For applicable Hydraulic Chuck collet, please refer to page 31~34.





# HYDRAULIC CHUCK

# HC

## HYDRAULIC CHUCK (SLIM)

HYDRAULIK SPANNFUTTER (SCHLANK)

Mandrin Hydraulique (mince)

Mandrini Idrraulici (sottile)

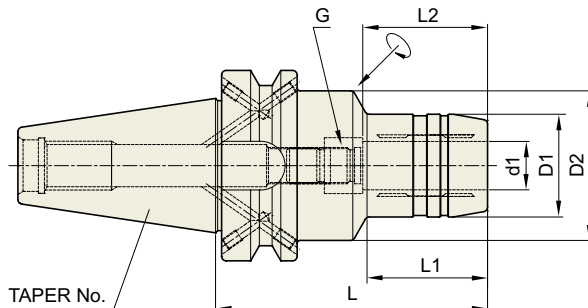

JIS B6339  
-BT

Taper  
Accuracy  
AT3

G Value  
2.5

RPM  
25,000

Run-Out  
(at 3D)  
≤3Um

Coolant  
System  
AD/B

### ■ JIS B6339/MAS 403-BT



Unit : mm

TAPER No.	MODEL No.	d1	D1	D2	L	L1	L2	G	Weight (Kg)	Stock
50	BT50AD/B-HC6-90	6	26	44.5	90	34	27	M5×0.8	3.75	●
	BT50AD/B-HC6-120	6	26	44.5	120	34	27	M5×0.8	4.10	
	BT50AD/B-HC6-150	6	26	44.5	150	34	27	M5×0.8	4.70	
	BT50AD/B-HC8-90	8	28	44.5	90	34	27	M6×1.0	3.75	●
	BT50AD/B-HC8-120	8	28	44.5	120	34	27	M6×1.0	4.10	
	BT50AD/B-HC8-150	8	28	44.5	150	34	27	M6×1.0	4.10	
	BT50AD/B-HC10-90	10	30	44.5	90	34	32	M8×1.0	3.90	●
	BT50AD/B-HC10-120	10	30	44.5	120	34	32	M8×1.0	4.30	
	BT50AD/B-HC10-150	10	30	44.5	150	34	32	M8×1.0	4.90	
	BT50AD/B-HC12-90	12	32	44.5	90	34	37	M10×1.0	3.90	●
	BT50AD/B-HC12-120	12	32	44.5	120	34	37	M10×1.0	4.30	
	BT50AD/B-HC12-150	12	32	44.5	150	34	37	M10×1.0	4.90	
	BT50AD/B-HC14-90	14	34	44.5	90	34	37	M10×1.0	3.90	
	BT50AD/B-HC14-120	14	34	44.5	120	34	37	M10×1.0	4.30	
	BT50AD/B-HC14-150	14	34	44.5	150	34	37	M10×1.0	4.90	
	BT50AD/B-HC16-90	16	38	44.5	90	34	42	M12×1.0	4.00	●
	BT50AD/B-HC16-120	16	38	44.5	120	34	42	M12×1.0	4.40	
	BT50AD/B-HC16-150	16	38	44.5	150	34	42	M12×1.0	5.00	
	BT50AD/B-HC18-90	18	40	44.5	90	34	42	M12×1.0	4.00	
	BT50AD/B-HC18-120	18	40	44.5	120	34	42	M12×1.0	4.40	
BT50AD/B-HC18-150	18	40	44.5	150	34	42	M12×1.0	5.00		
BT50AD/B-HC20-90	20	42	44.5	90	34	42	M16×1.0	4.00	●	
BT50AD/B-HC20-120	20	42	44.5	120	34	42	M16×1.0	4.40		
BT50AD/B-HC20-150	20	42	44.5	150	34	42	M16×1.0	5.00		
BT50AD/B-HC25-105	25	57	63	105	52	48	M16×1.0	4.40	●	
BT50AD/B-HC25-150	25	57	63	150	97	48	M16×1.0	5.60		
BT50AD/B-HC32-115	32	64	75	115	62	55	M16×1.0	4.70	●	
BT50AD/B-HC32-150	32	64	75	150	97	55	M16×1.0	6.00		

▶ CAT(ANSI B5.50) taper and Inch type products are available.

▶ For applicable Hydraulic Chuck collet, please refer to page 31~34.

**HYDRAULIC CHUCK (ULTRA SHORT)**

-  HYDRAULIK SPANNFUTTER (KURZ)
-  Mandrin Hydraulique (court)
-  Mandrini idraulici (corto)

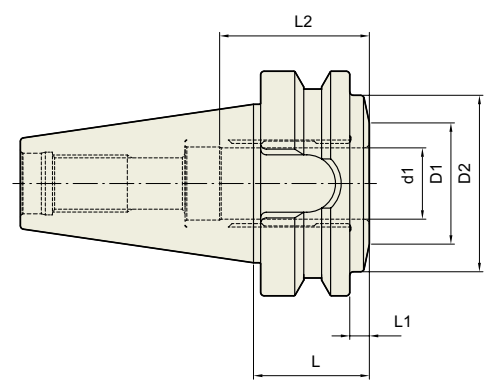

<b>JIS B6339</b> -BT	<b>Taper Accuracy</b> AT3	<b>G Value</b> 2.5	<b>RPM</b> 25,000	<b>Run-Out (at 3D)</b> ≤3Uμm	<b>Coolant System</b> AD
-------------------------	------------------------------	-----------------------	----------------------	---------------------------------	-----------------------------

**■ JIS B6339/MAS 403-BT**

Unit : mm

TAPER No.	MODEL No.	d1	D1	D2	L	L1	L2	G	Weight (Kg)	Stock
40	<b>BT40-HC20-24.6</b>	20	34	49.5	32.5	5.5	42	-		

- ▶ CAT(ANSI B5.50) taper and Inch type products area available.
- ▶ For applicable Hydraulic Chuck collet, please refer to page 31~34.

**HYDRAULIC CHUCK (For MOULD)**

 **HYDRAULIK SPANNFUTTER FÜR DEN FORMENBAU**

 **Mandrin Hydraulique pour mouliste**

 **Mandrini idraulici per stampaggio**

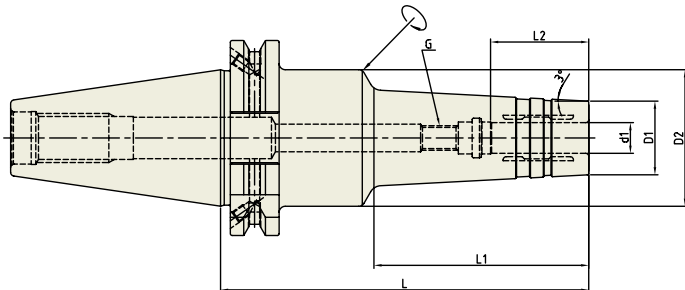

DIN 69871 -SK	Taper Accuracy AT3	G Value 2.5	RPM 25,000	Run-Out (at 3D) ≤3Um	Coolant System AD/B
------------------	--------------------------	----------------	---------------	----------------------------	---------------------------

 **DIN 69871-SK**

Unit : mm

TAPER No.	MODEL No.	d1	D1	D2	L	L1	L2	G	Weight (Kg)	Stock
40	SK40AD/B-HMC6-120	6	20	49.5	120	70	27	M5×0.8	1.40	
	SK40AD/B-HMC6-150	6	20	49.5	150	100	27	M5×0.8	1.65	●
	SK40AD/B-HMC8-120	8	22	49.5	120	70	27	M6×1.0	1.40	
	SK40AD/B-HMC8-150	8	22	49.5	150	100	27	M6×1.0	1.65	●
	SK40AD/B-HMC10-120	10	24	49.5	120	70	32	M8×1.0	1.40	
	SK40AD/B-HMC10-150	10	24	49.5	150	100	32	M8×1.0	1.65	●
	SK40AD/B-HMC12-120	12	25	49.5	120	70	37	M10×1.0	1.40	
	SK40AD/B-HMC12-150	12	25	49.5	150	100	37	M10×1.0	1.65	
	SK40AD/B-HMC16-120	16	32	49.5	120	70	42	M12×1.0	1.45	
	SK40AD/B-HMC16-150	16	32	49.5	150	100	42	M12×1.0	1.70	●
	SK40AD/B-HMC20-120	20	34	49.5	120	70	42	M16×1.0	1.50	
SK40AD/B-HMC20-150	20	34	49.5	150	100	42	M16×1.0	1.70		
50	SK50AD/B-HMC6-150	6	20	44.5	150	100	27	M5×0.8	4.50	
	SK50AD/B-HMC8-150	8	22	44.5	150	100	27	M6×1.0	4.50	
	SK50AD/B-HMC10-150	10	24	44.5	150	100	32	M8×1.0	4.50	
	SK50AD/B-HMC12-150	12	25	44.5	150	100	37	M10×1.0	4.50	
	SK50AD/B-HMC16-150	16	32	44.5	150	100	42	M12×1.0	4.70	
	SK50AD/B-HMC20-150	20	34	44.5	150	100	42	M16×1.0	5.00	

▶ CAT(ANSI B5.50) taper and Inch type products are available.

▶ For applicable Hydraulic Chuck collet, please refer to page 31~34.



## HYDRAULIC CHUCK (For MOULD)

HYDRAULIK SPANNFUTTER FÜR DEN FORMENBAU

Mandrin Hydraulique pour mouliste

Mandrini idraulici per stampaggio

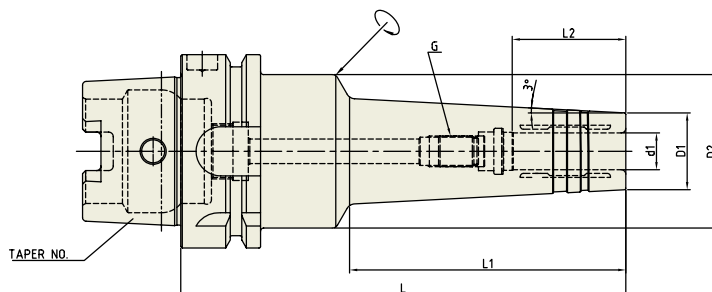

DIN 69893 -HSK	Taper Accuracy -	G Value 2.5	RPM 25,000	Run-Out (at 3D) ≤3Um	Coolant System AD
----------------	---------------------	----------------	---------------	-------------------------	----------------------

### ■ DIN 69893/ISO 12164-1-HSK FORM A

Unit : mm

TAPER No.	MODEL No.	d1	D1	D2	L	L1	L2	G	Weight (Kg)	Stock
63A	HSK63A-HMC6-145	6	20	50	145	90	27	M5×0.8	1.40	●
	HSK63A-HMC8-145	8	22	50	145	90	27	M6×1.0	1.40	●
	HSK63A-HMC10-145	10	24	50	145	90	32	M8×1.0	1.40	●
	HSK63A-HMC12-145	12	25	50	145	90	37	M10×1.0	1.40	●
	HSK63A-HMC16-145	16	32	50	145	90	42	M12×1.0	1.45	●
	HSK63A-HMC20-145	20	34	50	145	90	42	M16×1.0	1.50	●
100A	HSK100A-HMC6-150	6	20	50	150	90	27	M5×0.8	4.50	
	HSK100A-HMC8-150	8	22	50	150	90	27	M6×1.0	4.50	
	HSK100A-HMC10-150	10	24	50	150	90	32	M8×1.0	4.50	
	HSK100A-HMC12-150	12	25	50	150	90	37	M10×1.0	4.50	●
	HSK100A-HMC16-150	16	32	50	150	90	42	M12×1.0	4.70	
	HSK100A-HMC20-150	20	34	50	150	90	42	M16×1.0	5.00	●

► For applicable Hydraulic Chuck collet, please refer to page 31~34.



## HYDRAULIC CHUCK (For MOULD)

HYDRAULIK SPANNFUTTER FÜR DEN FORMENBAU

Mandrin Hydraulique pour mouliste

Mandrini idraulici per stampaggio

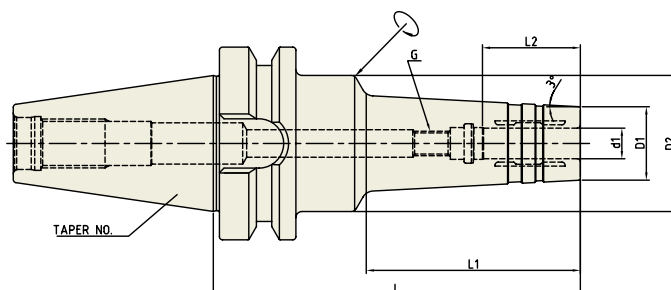

CBT	Taper Accuracy AT3	G Value 2.5	RPM 25,000	Run-Out (at 3D) ≤3Um	Coolant System AD
-----	-----------------------	----------------	---------------	-------------------------	----------------------

### ■ CBT (BT DUAL CONTACT)

Unit : mm

TAPER No.	MODEL No.	d1	D1	D2	L	L1	L2	G	Weight (Kg)	Stock
40	CBT40-HMC6-120	6	20	44.5	120	70	27	M5×0.8	1.40	
	CBT40-HMC6-150	6	20	44.5	150	100	27	M5×0.8	1.65	
	CBT40-HMC8-120	8	22	44.5	120	70	27	M6×1.0	1.40	
	CBT40-HMC8-150	8	22	44.5	150	100	27	M6×1.0	1.65	
	CBT40-HMC10-120	10	24	44.5	120	70	32	M8×1.0	1.40	
	CBT40-HMC10-150	10	24	44.5	150	100	32	M8×1.0	1.65	
	CBT40-HMC12-120	12	25	44.5	120	70	37	M10×1.0	1.40	
	CBT40-HMC12-150	12	25	44.5	150	100	37	M10×1.0	1.65	
	CBT40-HMC16-120	16	32	44.5	120	70	42	M12×1.0	1.45	
	CBT40-HMC16-150	16	32	44.5	150	100	42	M12×1.0	1.70	
	CBT40-HMC20-120	20	34	43.8	120	93	42	M16×1.0	1.50	
	CBT40-HMC20-150	20	34	46.9	150	123	42	M16×1.0	1.80	
50	CBT50-HMC6-150	6	20	50	150	90	27	M5×0.8	4.70	
	CBT50-HMC8-150	8	22	50	150	90	27	M6×1.0	4.70	
	CBT50-HMC10-150	10	24	50	150	90	32	M8×1.0	4.70	
	CBT50-HMC12-150	12	25	50	150	90	37	M10×1.0	4.70	
	CBT50-HMC16-150	16	32	50	150	90	42	M12×1.0	4.90	
	CBT50-HMC20-150	20	34	50	150	90	42	M16×1.0	5.00	

► For applicable Hydraulic Chuck collet, please refer to page 31~34.



## HYDRAULIC CHUCK (For MOULD)

HYDRAULIK SPANNFUTTER FÜR DEN FORMENBAU

Mandrin Hydraulique pour mouliste

Mandrini idraulici per stampaggio

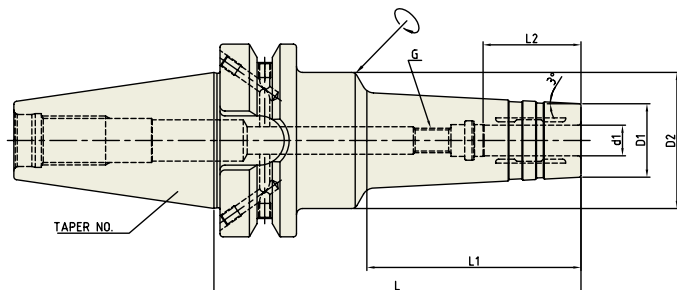

JIS B6339 -BT	Taper Accuracy AT3	G Value 2.5	RPM 25,000	Run-Out (at 3D) ≤3Uμm	Coolant System AD/B
---------------	-----------------------	----------------	---------------	--------------------------	------------------------

### JIS B6339/MAS 403-BT

Unit : mm

TAPER No.	MODEL No.	d1	D1	D2	L	L1	L2	G	Weight (Kg)	Stock
40	BT40AD/B-HMC6-120	6	20	44.5	120	70	27	M5×0.8	1.40	
	BT40AD/B-HMC6-150	6	20	44.5	150	100	27	M5×0.8	1.65	
	BT40AD/B-HMC8-120	8	22	44.5	120	70	27	M6×1.0	1.40	
	BT40AD/B-HMC8-150	8	22	44.5	150	100	27	M6×1.0	1.65	
	BT40AD/B-HMC10-120	10	24	44.5	120	70	32	M8×1.0	1.40	
	BT40AD/B-HMC10-150	10	24	44.5	150	100	32	M8×1.0	1.65	
	BT40AD/B-HMC12-120	12	25	44.5	120	70	37	M10×1.0	1.40	●
	BT40AD/B-HMC12-150	12	25	44.5	150	100	37	M10×1.0	1.65	
	BT40AD/B-HMC16-120	16	32	44.5	120	70	42	M12×1.0	1.45	
	BT40AD/B-HMC16-150	16	32	44.5	150	100	42	M12×1.0	1.70	
	BT40AD/B-HMC20-120	20	34	43.8	120	93	42	M16×1.0	1.50	●
	BT40AD/B-HMC20-150	20	34	46.9	150	123	42	M16×1.0	1.80	
50	BT50AD/B-HMC6-150	6	20	50	150	90	27	M5×0.8	4.70	
	BT50AD/B-HMC8-150	8	22	50	150	90	27	M6×1.0	4.70	
	BT50AD/B-HMC10-150	10	24	50	150	90	32	M8×1.0	4.70	
	BT50AD/B-HMC12-150	12	25	50	150	90	37	M10×1.0	4.70	●
	BT50AD/B-HMC16-150	16	32	50	150	90	42	M12×1.0	4.90	
	BT50AD/B-HMC20-150	20	34	50	150	90	42	M16×1.0	5.00	●

▶ CAT(ANSI B5.50) taper and Inch type products are available.

▶ For applicable Hydraulic Chuck collet, please refer to page 31~34.



# HYDRAULIC CHUCK

# HC

## HYDRAULIC CHUCK (FOR GRINDER)

HYDRAULIK SPANNFUTTER FÜ DEN FORMENBAU

Mandrin Hydraulique pour mouliste

Mandrini idraulici per stampaggio

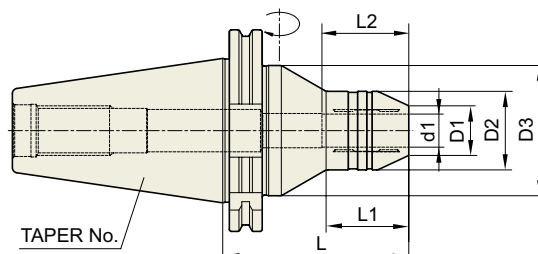

DIN 69871 -SK	Taper Accuracy AT3	Run-Out (at 3D) ≤3Um	Coolant System AD
------------------	-----------------------	-------------------------	----------------------

### ■ DIN 69871-SK

Unit : mm

TAPER No.	MODEL No.	d1	D1	D2	D3	L	L1	L2	Weight (Kg)	Stock
50	SK50-HC6G-90	6	14	30	63	90	30	27	3.00	●
	SK50-HC8G-90	8	16	30	63	90	30	27	3.00	●
	SK50-HC10G-90	10	18	30	63	90	30	32	3.00	●
	SK50-HC12G-90	12	21	33	63	90	35	37	3.05	●
	SK50-HC14G-90	14	22	35	63	90	35	37	3.10	●
	SK50-HC16G-90	16	24	38	63	90	40	42	3.10	●
	SK50-HC18G-90	18	26	40	63	90	40	42	3.10	●
	SK50-HC20G-110	20	29	42	63	110	40	42	3.30	●
	SK50-HC25G-110	25	34	50	70	110	45	48	3.60	●
SK50-HC32G-110	32	42	56	80	110	50	55	4.20	●	

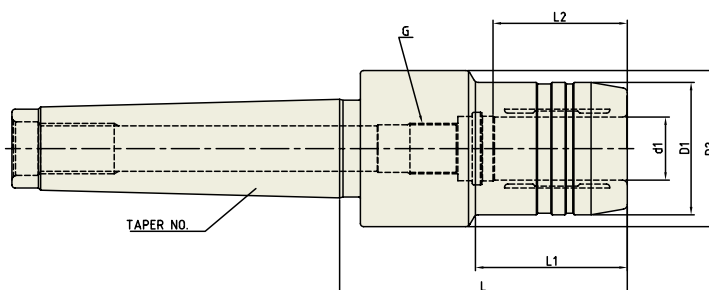

### ■ DIN 228-MTB

Unit : mm

TAPER No.	MODEL No.	d1	D1	D2	L	L1	L2	G	Weight (Kg)	Stock
4	MTB4-HC20-90	20	42	49.5	90	47.5	42	M16×1.0	1.30	●
	MTB4-HC32-90	32	72	72	90	-	55	-	1.40	●
5	MTB5-HC20-90	20	42	49.5	90	47.5	42	M16×1.0	2.20	●
	MTB5-HC32-90	32	72	72	90	-	55	-	2.40	●



**HYDRAULIC CHUCK COLLET (REDUCTION SLEEVE : OPEN TYPE)**

■ HYDRAULIK SPANNFUTTER SPANNZANGE (GESCHLITZTE ZWISCHENBUCHSE)

■ Mandrin Hydraulique Pince de serrage (Douille fendue)

■ Mandrini Idraulici Pinza di serraggio (Bussola di riduzione fessurata)

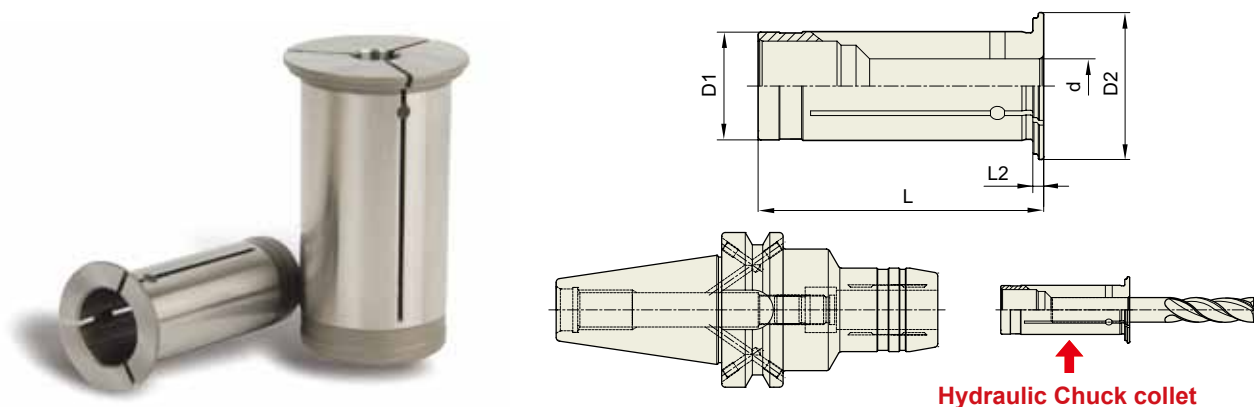

Unit : mm

MODEL No.		d	D1	D2	L	L2
HK12	3	3	12	19	47	2
	4	4	12	19	47	2
	5	5	12	19	47	2
	6	6	12	19	47	2
	7	7	12	19	47	2
	8	8	12	19	47	2
HK20	3	3	20	27	52.5	2
	4	4	20	27	52.5	2
	5	5	20	27	52.5	2
	6	6	20	27	52.5	2
	7	7	20	27	52.5	2
	8	8	20	27	52.5	2
	9	9	20	27	52.5	2
	10	10	20	27	52.5	2
	11	11	20	27	52.5	2
	12	12	20	27	52.5	2
	13	13	20	27	52.5	2
	14	14	20	27	52.5	2
HK32	6	6	32	39	63.5	3
	8	8	32	39	63.5	3
	10	10	32	39	63.5	3
	12	12	32	39	63.5	3
	14	14	32	39	63.5	3
	16	16	32	39	63.5	3
	18	18	32	39	63.5	3
	20	20	32	39	63.5	3
	25	25	32	39	63.5	3

▶ Stock Control Item

▶ Inch type products are available.

▶ Other special sizes of Hydraulic Chuck collets could be produced and supplied

**▶ Feature**

HK Hydraulic Chuck collet (reduction sleeve) is cut into trisection by high precision cutting to guarantee precise I.D and strong clamping power.

**▶ Chucking Method**

Please assemble cutting tool with collet firstly, and then insert collet into Hydraulic Chuck.

# HYDRAULIC CHUCK

# HS

## HYDRAULIC CHUCK COLLET (REDUCTION SLEEVE : CLOSED TYPE)

 HYDRAULIK SPANNFUTTER SPANNZANGE

 Mandrin Hydraulique Pince de serrage

 Mandrini Idraulici Pinza di serraggio

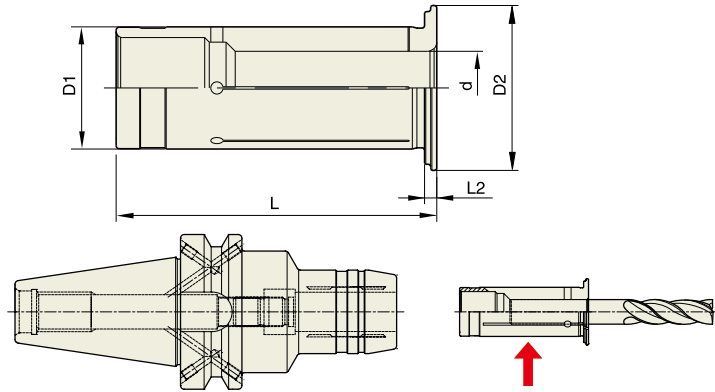

Hydraulic Chuck collet

Unit : mm



MODEL No.	d	D1	D2	L	L2
HS12	3	12	19	47	2
	4	12	19	47	2
	5	12	19	47	2
	6	12	19	47	2
	7	12	19	47	2
	8	12	19	47	2
HS20	3	20	27	52.5	2
	4	20	27	52.5	2
	5	20	27	52.5	2
	6	20	27	52.5	2
	7	20	27	52.5	2
	8	20	27	52.5	2
	9	20	27	52.5	2
	10	20	27	52.5	2
	11	20	27	52.5	2
	12	20	27	52.5	2
	13	20	27	52.5	2
	14	20	27	52.5	2
HS32	6	32	39	63.5	3
	8	32	39	63.5	3
	10	32	39	63.5	3
	12	32	39	63.5	3
	14	32	39	63.5	3
	16	32	39	63.5	3
	18	32	39	63.5	3
	20	32	39	63.5	3
25	32	39	63.5	3	

- ▶ Stock Control Item
- ▶ Inch type products are available.
- ▶ Other special sizes of Hydraulic Chuck collets could be produced and supplied

**▶ Feature** HS Hydraulic Chuck collet (reduction sleeve) is cut by high precision wire-cutting to guarantee precise I.D and strong clamping power.

**▶ Chucking Method** Please assemble cutting tool with collet firstly, and then insert collet into Hydraulic Chuck.

**HYDRAULIC CHUCK COLLET (REDUCTION SLEEVE : COOLANT FLUSH TYPE)**

-  HYDRAULIK SPANNFUTTER SPANNZANGE
-  Mandrin Hydraulique Pince de serrage
-  Mandrini Idraulici Pinza di serraggio

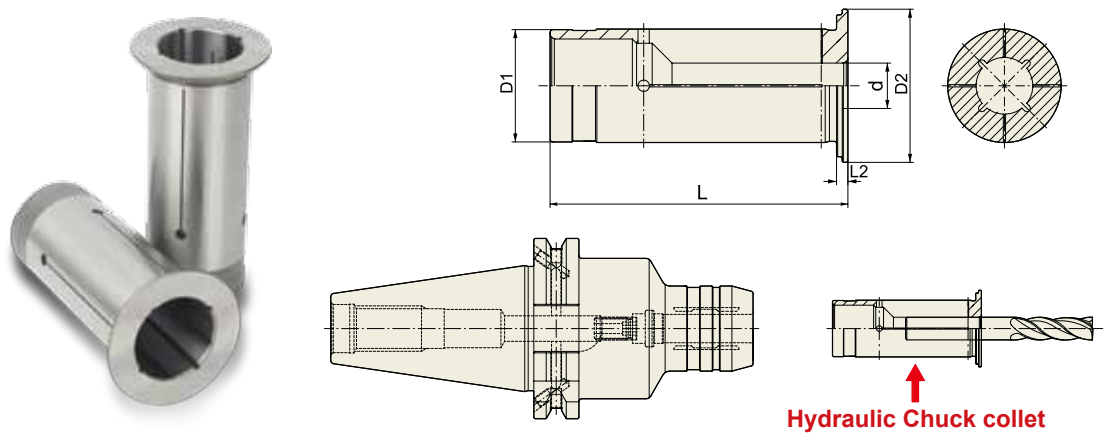

Unit : mm

MODEL No.	d	D1	D2	L	L2
HF12	3	12	19	47	2
	4	12	19	47	2
	5	12	19	47	2
	6	12	19	47	2
	7	12	19	47	2
	8	12	19	47	2
HF20	3	20	27	52.5	2
	4	20	27	52.5	2
	5	20	27	52.5	2
	6	20	27	52.5	2
	7	20	27	52.5	2
	8	20	27	52.5	2
	9	20	27	52.5	2
	10	20	27	52.5	2
	11	20	27	52.5	2
	12	20	27	52.5	2
	13	20	27	52.5	2
	14	20	27	52.5	2
HF32	6	32	39	63.5	3
	8	32	39	63.5	3
	10	32	39	63.5	3
	12	32	39	63.5	3
	14	32	39	63.5	3
	16	32	39	63.5	3
	18	32	39	63.5	3
	20	32	39	63.5	3
25	32	39	63.5	3	

- ▶ Stock Control Item
- ▶ Inch type products are available.
- ▶ Other special sizes of Hydraulic Chuck collets could be produced and supplied

**▶ Feature** HF Hydraulic Chuck collet (reduction sleeve) is for internal coolant flush.

**▶ Chucking Method** Please assemble cutting tool with collet firstly, and then insert collet into Hydraulic Chuck.

# HYDRAULIC CHUCK

# HR

## HYDRAULIC CHUCK COLLET (REDUCTION SLEEVE : for HIGH PRESSURE COOLANT)

 HYDRAULIK SPANNFUTTER SPANNZANGE

 Mandrin Hydraulique Pince de serrage

 Mandrini Idrraulici Pinza di serraggio

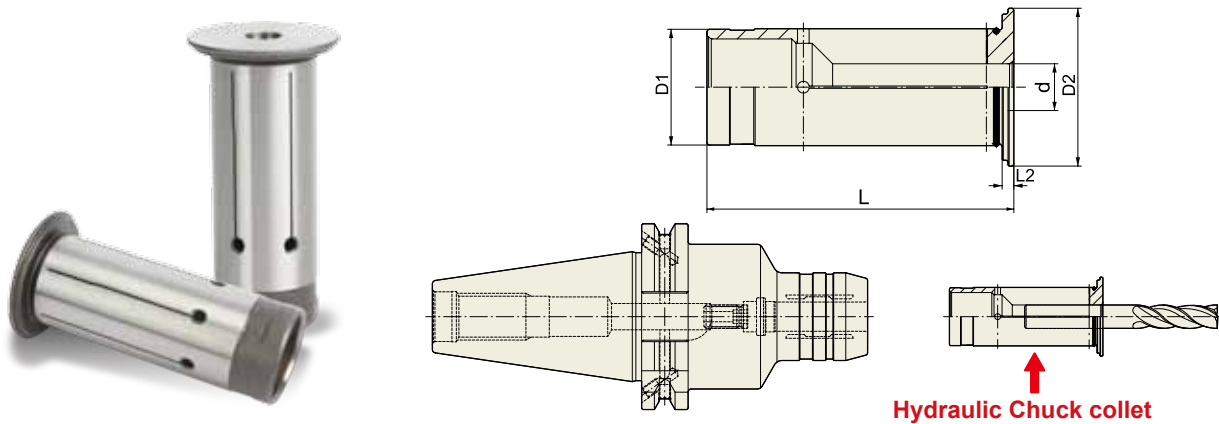

Unit : mm

MODEL No.	d	D1	D2	L	L2
HR12	3	12	19	47	2
	4	12	19	47	2
	5	12	19	47	2
	6	12	19	47	2
	7	12	19	47	2
	8	12	19	47	2
HR20	3	20	27	52.5	2
	4	20	27	52.5	2
	5	20	27	52.5	2
	6	20	27	52.5	2
	7	20	27	52.5	2
	8	20	27	52.5	2
	9	20	27	52.5	2
	10	20	27	52.5	2
	11	20	27	52.5	2
	12	20	27	52.5	2
	13	20	27	52.5	2
	14	20	27	52.5	2
	15	20	27	52.5	2
HR32	6	32	39	63.5	3
	8	32	39	63.5	3
	10	32	39	63.5	3
	12	32	39	63.5	3
	14	32	39	63.5	3
	16	32	39	63.5	3
	18	32	39	63.5	3
	20	32	39	63.5	3
25	32	39	63.5	3	

- ▶ Stock Control Item
- ▶ Inch type products are available.
- ▶ Other special sizes of Hydraulic Chuck collets could be produced and supplied

**▶ Feature**

HR Hydraulic Chuck collet (reduction sleeve) is for high pressure coolant supply.

**▶ Chucking Method**

Please assemble cutting tool with collet firstly, and then insert collet into Hydraulic Chuck.